

PANELLI®

Italian excellence since 1906

6" 8" 10"

140 REC - 180 REC | 50Hz
230 REC

**POMPA SOMMERSA
SEMIASSIALE - GHISA
SEMIAXIAL SUBMERSIBLE
PUMP - CAST IRON**



MADE IN ITALY



6" 8" 10" 140 REC
180 REC | **50Hz**
230 REC

POMPA SOMMERSA SEMIASSIALE - GHISA
SEMIAXIAL SUBMERSIBLE PUMP - CAST IRON

Pompa semiassiale in ghisa: 6", 8" e 10"

6", 8" and 10" cast iron semiaxial pump

Pompe semiaxiale en fonte 6", 8" et 10"

Bomba semiaxial en hierro 6", 8" y 10"

Ampia gamma da 34 m³/ora a 240 m³/ora

Extensive range from 34 m³/hour up to 240 m³/hour

Gamme très complète de 34 m³/heure jusqu'à 240 m³/heure

Gama muy amplia de 34 m³/hora hasta 240 m³/hora

PANELLI®

Italian excellence since 1906

Tolleranza alla sabbia 50 g/m³ - sand tolerance 50 g/m³
Tolleranze secondo UNI ISO 9906 livello 3B - Tolerances according to UNI ISO 9906 grade 3B

PANNELLI®

Italian excellence since 1906

6" 8" 10" 140 REC
180 REC | **50Hz**
230 REC

POMPA SOMMERSA SEMIASSIALE - GHISA
SEMIAXIAL SUBMERSIBLE PUMP - CAST IRON

Girante e diffusore in ghisa

Impeller and diffuser in cast iron

Roue et diffuseur en fonte

Rodete y difusor en hierro

Robustezza ineguagliabile

Heavy Duty construction

Durabilità

Durabilidad



6" - 8" - 10" REC



6" 8" 10" 140 REC
180 REC | 50Hz
230 REC

POMPA SOMMERSA SEMIASSIALE - GHISA SEMIAXIAL SUBMERSIBLE PUMP - CAST IRON



ELETTROPOMPE SOMMERSE SEMIASSIALI 6"/8"/10" SERIE 140/180/230 REC, IN GHISA MECCANICA G25

Le pompe sommerse semiassiali sono caratterizzate da stadi formati dal corpo diffusore incorporato e girante semiassiale. Questo tipo di soluzione, rispetto a quella radiale, è ideale quando sono richieste a parità di diametro, medio-alte portate, con medie prevalenze. Adatte a sollevamento di acqua pulita, per approvvigionamento idrico ad uso civile ed industriale, impianti di pressurizzazione, antincendio ed irrigazione, acquedotti.

VANTAGGI

- rendimenti elevati
- facilità di smontaggio
- ridotta manutenzione
- bassi costi di esercizio

MATERIALI

- Girante, diffusore, gabbia di aspirazione e corpo valvola in ghisa meccanica G25
- Albero pompa in acciaio inox Aisi 304
- Anelli di usura, bronzine, guarnizione valvola in gomma NBR
- Anello di contropinta in PTFE+25% GRAFITE

CAMPI DI PRESTAZIONE IDRAULICHE

- Portate fino a 300 m³/h
- Prevalenze fino a 450 metri
- Potenze fino a 147 Kw
- Massima quantità di sabbia ammessa : 50 g/m³
- Massima profondità di immersione : 300 metri.



6"/8"/10" SUBMERSIBLE SEMIAXIAL PUMPS SERIES 140/180/230 REC, IN CAST IRON

The semi axial pumps impellers with diffusers integrated. These pumps are usually ideal for medium-high capacity and medium head required. PANELLI production offer standard semi-axial pumps from 6" to 10".

ADVANTAGES

Panelli innovative design and the most advanced micro casting technologies allow:

- High efficiency
- Longer life
- Easy assembly/disassembly
- Low maintenance
- Low operating cost

MATERIALS

- Impellers, diffusers, suction cage and delivery bowl in cast iron
- Pump shaft in AISI 304 stainless steel
- Wear rings, bearing buses, valve seal in NBR
- Counter thrust in PTFE+25% GRAPHITE

HYDRAULIC PERFORMANCES

- Capacity up to 300 m³/h
- Head up to 450 m
- Power up to 147 kW
- Maximum sand tolerance : 50g/m³
- Maximum depth : 300 metres

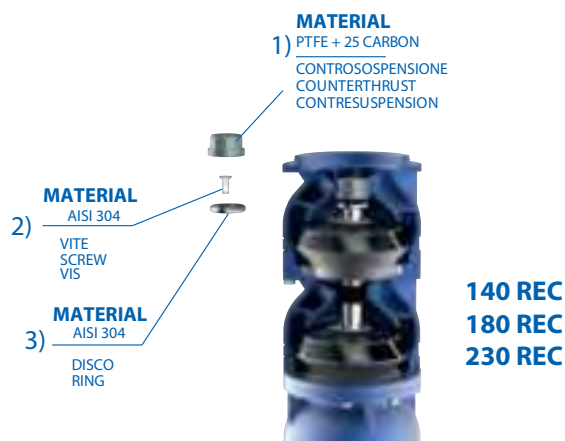

Tolleranza alla sabbia 50 g/m³ - sand tolerance 50 g/m³
Tolleranze secondo UNI ISO 9906 livello 3B - Tolerances according to UNI ISO 9906 grade 3B

PANELLI®

Italian excellence since 1906

6" 8" 10" 140 REC | 180 REC | 230 REC | 50Hz

POMPA SOMMERSA SEMIASSIALE - GHISA SEMIAXIAL SUBMERSIBLE PUMP - CAST IRON



POMPES IMMERGÉES SEMIAXIALES 6"/8"/10" SERIE 140/180/230 REC, EN FONTE

Les pompes immergées semiaxiales grâce au design des roues et des diffuseurs peuvent produire des débits moyens élevés et des hauteurs moyennes.

Les pompes sont conçues pour des eaux claires dans toutes applications domestiques, industrielles, systèmes de suppression, groupe incendie, irrigation et réseaux d'eau publiques.

ADVANTAGES

L'innovatif projet Panelli et les technologies de microfusion les plus modernes permettent d'obtenir:

- Très hautes efficacités
- Durée de vie importante
- Facilité de montage et démontage
- Manutention réduite
- Coûts d'exercice réduits

MATERIAUX

- Roues, diffuseurs, cage d'aspiration et refoulement en fonte
- Axe de la pompe en acier inoxydable AISI 304
- Bagues d'usure, bagues, anneau du clapet en caoutchouc NBR
- Contresuspension en PTFE+25% GRAPHITE

PERFORMANCES HYDRAULIQUES

- Débit jusqu'à 300 m³/h
- Hauteur jusqu'à 450 m
- Puissance jusqu'à 147 kW
- Tolerance de sable maximum : 50 g/m³
- Profondeur maximum d'immersion: 300 mètres



BOMBAS SUMERGIBLES SEMIAXIALES 6"/8"/10" SERIE 140/180/230 REC, EN HIERRO FUNDIDO

Las bombas sumergibles semiaxiales gracias al design de los impulsores y de los cuerpos se adaptan a caudales medio-elevados y alturas media. Concebidas para el bombeo de aguas limpias en aplicaciones civiles e industriales para el suministro de agua a nivel doméstico, industrial, en grupos de presión, sistemas contra incendio, riego y sistemas de agua pública.

VENTAJAS

El design innovativo Panelli y las tecnologías más modernas garantizan:

- Eficacias elevadas
- Durada de vida muy importante
- Facilidad de montaje y desmontaje - Manutención mínima
- Costos de utilización muy limitados

MATERIALES

- Impulsores, difusores, caja de aspiración e impulsión en hierro fundido
- Eje de bomba en acero inoxidable AISI 304
- Anillos de usura, bocina y anillo válvula en goma NBR.
- Contraempuje en PTFE+25% GRAFITO

PRESTACIONES HIDRAULICAS

- Caudales hasta 300 m³/h, Alturas hasta 450 m, Potencia hasta 147 kW
- Cantida máx de arena contenida en el agua: 50g/m³, Sumergencia máx: 300 metros



Tolleranza alla sabbia 50 g/m³ - sand tolerance 50 g/m³
Tolleranze secondo UNI ISO 9906 livello 3B - Tolerances according to UNI ISO 9906 grade 3B

CARATTERISTICHE IDRAULICHE - HYDRAULIC PERFORMANCES

Q= Portata - Capacity - Debit **50 Hz n= 2900 min**

| Tipo Type | Power | | H(m) | 0 | 300 | 400 | 500 | 600 | 700 | 800 | | |
|---------------|-------|------|------|-------|-------|-------------------|-------|-------|-------------------|-------|-------|-------------------|
| | kW | HP | | l/min | l/sec | m ³ /h | l/min | l/sec | m ³ /h | l/min | l/sec | m ³ /h |
| | | | | 0 | 5 | 6,67 | 8,33 | 10 | 11,67 | 13,33 | | |
| 140 REC 34/03 | 4 | 5,5 | 43 | 36 | 33 | 30 | 27 | 22 | 15 | | | |
| 140 REC 34/04 | 5,5 | 7,5 | 57 | 48 | 44 | 40 | 37 | 30 | 20 | | | |
| 140 REC 34/05 | 7,5 | 10 | 71 | 60 | 55 | 50 | 46 | 37 | 25 | | | |
| 140 REC 34/06 | 7,5 | 10 | 86 | 72 | 66 | 60 | 55 | 45 | 30 | | | |
| 140 REC 34/07 | 9,2 | 12,5 | 100 | 84 | 77 | 70 | 64 | 52 | 35 | | | |
| 140 REC 34/08 | 11 | 15 | 114 | 96 | 88 | 80 | 73 | 59 | 40 | | | |
| 140 REC 34/09 | 11 | 15 | 129 | 108 | 99 | 90 | 82 | 67 | 45 | | | |
| 140 REC 34/10 | 13 | 17,5 | 143 | 120 | 110 | 100 | 91 | 74 | 50 | | | |
| 140 REC 34/11 | 13 | 17,5 | 157 | 132 | 121 | 110 | 101 | 82 | 55 | | | |
| 140 REC 34/12 | 15 | 20 | 171 | 144 | 132 | 120 | 110 | 89 | 60 | | | |
| 140 REC 34/13 | 15 | 20 | 186 | 156 | 143 | 130 | 119 | 97 | 65 | | | |
| 140 REC 34/14 | 18,5 | 25 | 200 | 168 | 154 | 140 | 128 | 104 | 70 | | | |
| 140 REC 34/15 | 18,5 | 25 | 214 | 180 | 165 | 150 | 137 | 111 | 75 | | | |

DIMENSIONI D'INGOMBRO E PESI - OVERALL DIMENSIONS AND WEIGHTS

| Type | A mm Tri V 400 | B mm | C mm Tri | M Kg Tri | P Kg |
|---------------|-------------------|------|----------|----------|------|
| 140 REC 34/03 | 1242 | 596 | 646 | 40 | 19 |
| 140 REC 34/04 | 1368 | 697 | 671 | 45 | 23 |
| 140 REC 34/05 | 1499 | 798 | 701 | 55 | 28 |
| 140 REC 34/06 | 1600 | 899 | 701 | 55 | 32 |
| 140 REC 34/07 | 1751 | 1000 | 751 | 60 | 36 |
| 140 REC 34/08 | 1912 | 1101 | 811 | 65 | 40 |
| 140 REC 34/09 | 2013 | 1202 | 811 | 65 | 44 |
| 140 REC 34/10 | 2144 | 1303 | 841 | 70 | 48 |
| 140 REC 34/11 | 2245 | 1404 | 841 | 70 | 52 |
| 140 REC 34/12 | 2436 | 1505 | 931 | 75 | 56 |
| 140 REC 34/13 | 2537 | 1606 | 931 | 75 | 60 |
| 140 REC 34/14 | 2698 | 1707 | 991 | 83 | 64 |
| 140 REC 34/15 | 2799 | 1808 | 991 | 83 | 69 |

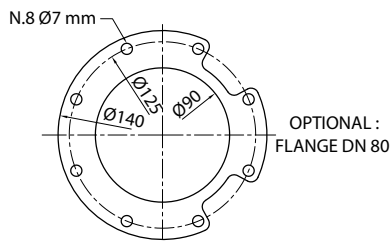
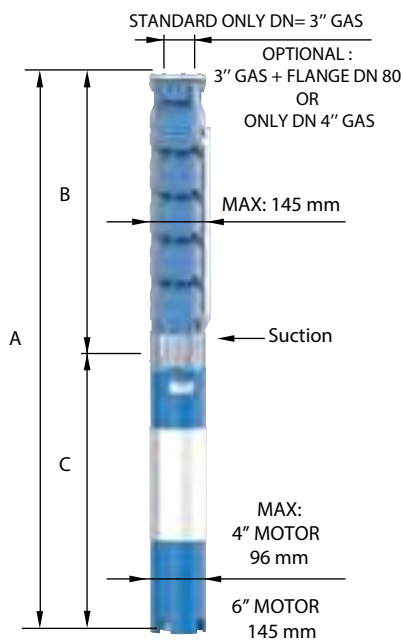

FOR COMMERCIAL PIPE
EXTERNAL DIAMETER: 88,9 mm

n% = Rendimento della pompa
n% = Rendement de la pompe
n% = Pump efficiency
n% = Rendimiento de la bomba

**Max
74%**

kW/st = Assorbimento per stadio
kW/st = Absorption par étage
kW/st = Stage absorption
kW/st = Potencia absorbida por etapa

**Max
1,22**

Tolleranza alla sabbia 50 g/m³ - Sand tolerance 50 g/m³
Tolleranze secondo UNI ISO 9906 livello 3B - Tolerances according to UNI ISO 9906 grade 3B

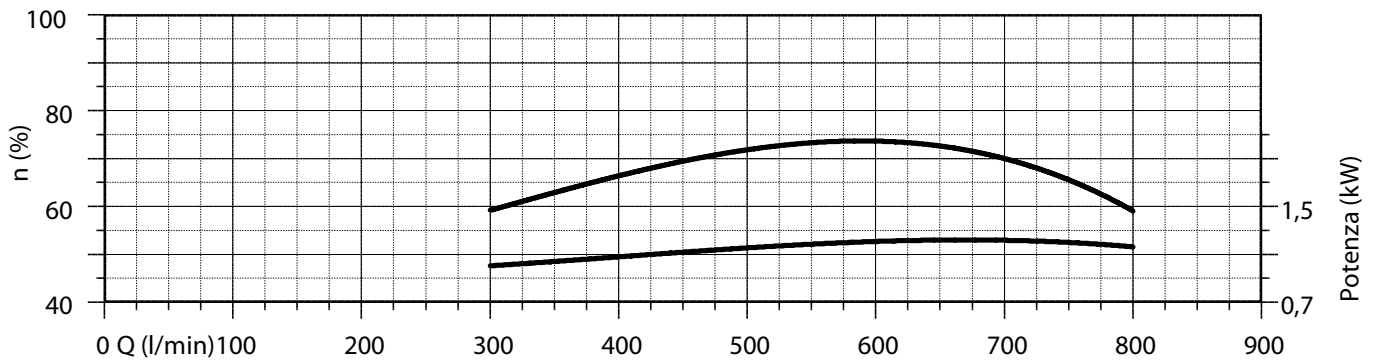
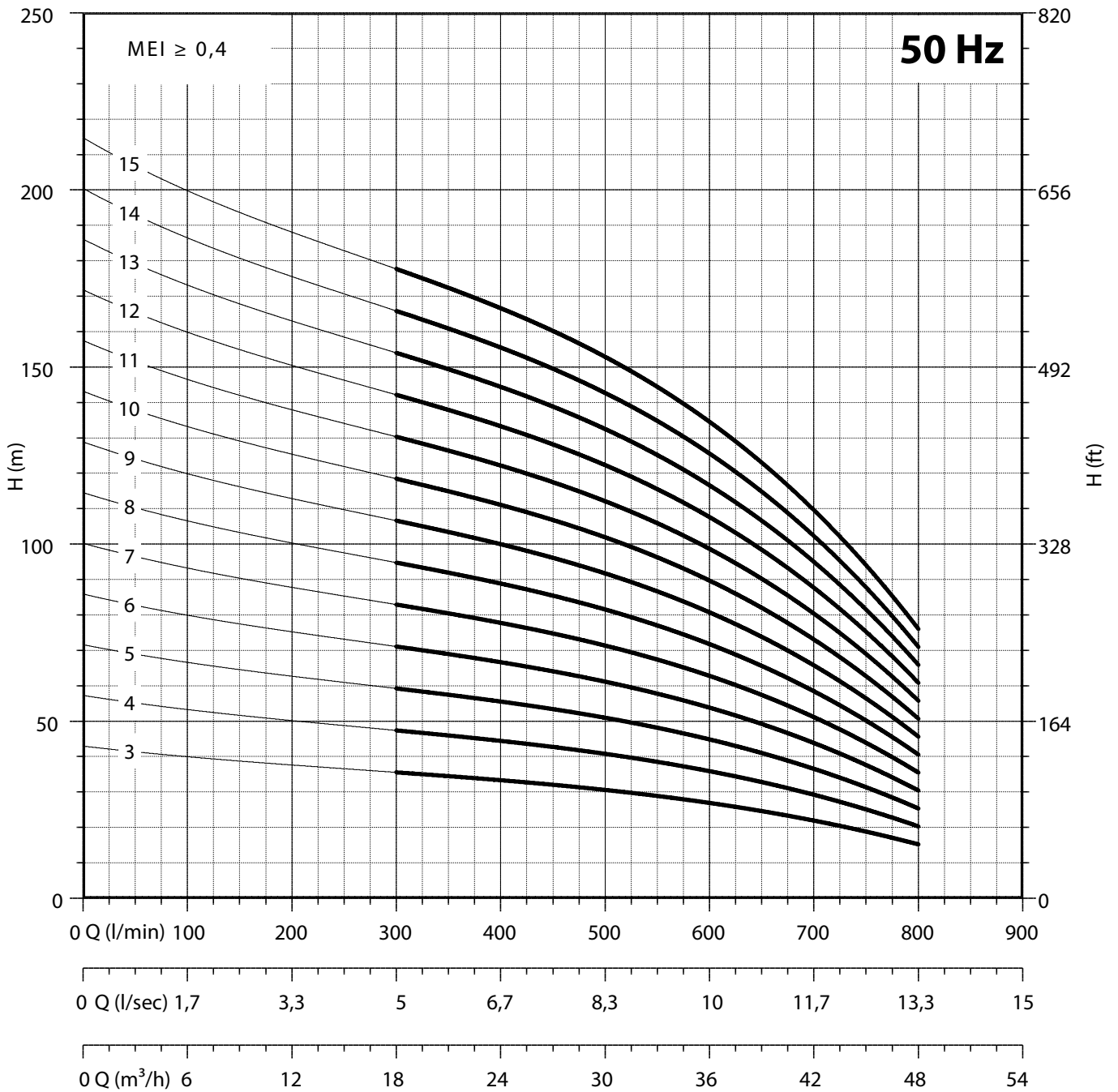

| NPSH (m) | 25% | 50% | 75% | 100% |
|------------|-----|-----|-----|------|
| 140 REC 34 | 3,4 | 3,4 | 3,8 | 8 |

CARATTERISTICHE IDRAULICHE - HYDRAULIC PERFORMANCES

Q= Portata - Capacity - Debit **50 Hz n= 2900 min**

| Tipo Type | Power | | H(m) | 0 | 300 | 400 | 500 | 600 | 700 | 800 |
|---------------|-------|----|------|-------------------|-------|-------|-------|-------|-------|-------|
| | kW | HP | | l/min | l/sec | l/sec | l/sec | l/sec | l/sec | l/sec |
| | | | | m ³ /h | 0 | 18 | 24 | 30 | 36 | 42 |
| 140 REC 34/16 | 22 | 30 | | 229 | 192 | 176 | 160 | 146 | 119 | 80 |
| 140 REC 34/17 | 22 | 30 | | 243 | 204 | 187 | 170 | 155 | 126 | 85 |
| 140 REC 34/18 | 22 | 30 | | 257 | 216 | 198 | 180 | 165 | 134 | 90 |
| 140 REC 34/19 | 26 | 35 | | 271 | 228 | 209 | 190 | 174 | 141 | 95 |
| 140 REC 34/20 | 26 | 35 | | 286 | 240 | 220 | 200 | 183 | 149 | 100 |
| 140 REC 34/21 | 26 | 35 | | 300 | 252 | 231 | 210 | 192 | 156 | 105 |
| 140 REC 34/22 | 26 | 35 | | 314 | 264 | 242 | 220 | 201 | 163 | 110 |
| 140 REC 34/23 | 30 | 40 | | 329 | 276 | 253 | 230 | 210 | 171 | 115 |
| 140 REC 34/24 | 30 | 40 | | 343 | 288 | 264 | 240 | 219 | 178 | 120 |
| 140 REC 34/25 | 30 | 40 | | 357 | 300 | 275 | 250 | 229 | 186 | 125 |
| 140 REC 34/26 | 37 | 50 | | 371 | 312 | 286 | 260 | 238 | 193 | 130 |
| 140 REC 34/27 | 37 | 50 | | 386 | 324 | 297 | 270 | 247 | 201 | 135 |
| 140 REC 34/28 | 37 | 50 | | 400 | 336 | 308 | 280 | 256 | 208 | 140 |
| 140 REC 34/29 | 37 | 50 | | 414 | 348 | 319 | 290 | 265 | 215 | 145 |
| 140 REC 34/30 | 37 | 50 | | 429 | 360 | 330 | 300 | 274 | 223 | 150 |

DIMENSIONI D'INGOMBRO E PESI - OVERALL DIMENSIONS AND WEIGHTS

| Type | A mm Tri V 400 | B mm | C mm Tri | M Kg Tri | P Kg |
|---------------|-------------------|------|----------|----------|------|
| 140 REC 34/16 | 2980 | 1909 | 1071 | 92 | 73 |
| 140 REC 34/17 | 3081 | 2010 | 1071 | 92 | 77 |
| 140 REC 34/18 | 3182 | 2111 | 1071 | 92 | 81 |
| 140 REC 34/19 | 3393 | 2212 | 1181 | 100 | 85 |
| 140 REC 34/20 | 3494 | 2313 | 1181 | 100 | 89 |
| 140 REC 34/21 | 3595 | 2414 | 1181 | 100 | 93 |
| 140 REC 34/22 | 3696 | 2515 | 1181 | 100 | 97 |
| 140 REC 34/23 | 3867 | 2616 | 1251 | 108 | 101 |
| 140 REC 34/24 | 3968 | 2717 | 1251 | 108 | 105 |
| 140 REC 34/25 | 4069 | 2818 | 1251 | 108 | 110 |
| 140 REC 34/26 | 4260 | 2919 | 1341 | 118 | 114 |
| 140 REC 34/27 | 4361 | 3020 | 1341 | 118 | 118 |
| 140 REC 34/28 | 4462 | 3121 | 1341 | 118 | 122 |
| 140 REC 34/29 | 4563 | 3222 | 1341 | 118 | 126 |
| 140 REC 34/30 | 4664 | 3323 | 1341 | 118 | 130 |

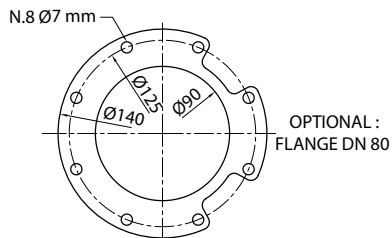
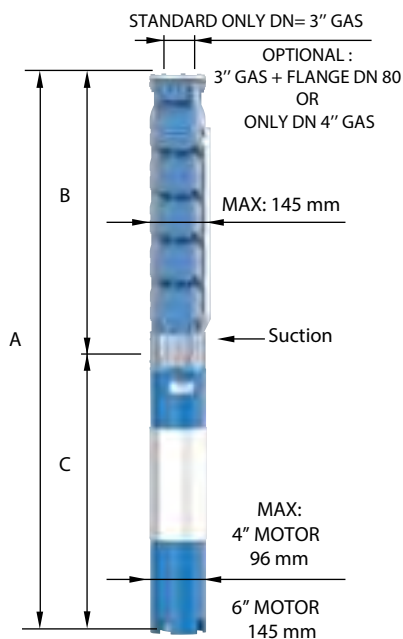

FOR COMMERCIAL PIPE
EXTERNAL DIAMETER: 88,9 mm

n% = Rendimento della pompa
n% = Rendement de la pompe
n% = Pump efficiency
n% = Rendimiento de la bomba

**Max
74%**

kW/st = Assorbimento per stadio
kW/st = Absorption par étage
kW/st = Stage absorption
kW/st = Potencia absorbida por etapa

**Max
1,22**

Tolleranza alla sabbia 50 g/m³ - Sand tolerance 50 g/m³
Tolleranze secondo UNI ISO 9906 livello 3B - Tolerances according to UNI ISO 9906 grade 3B

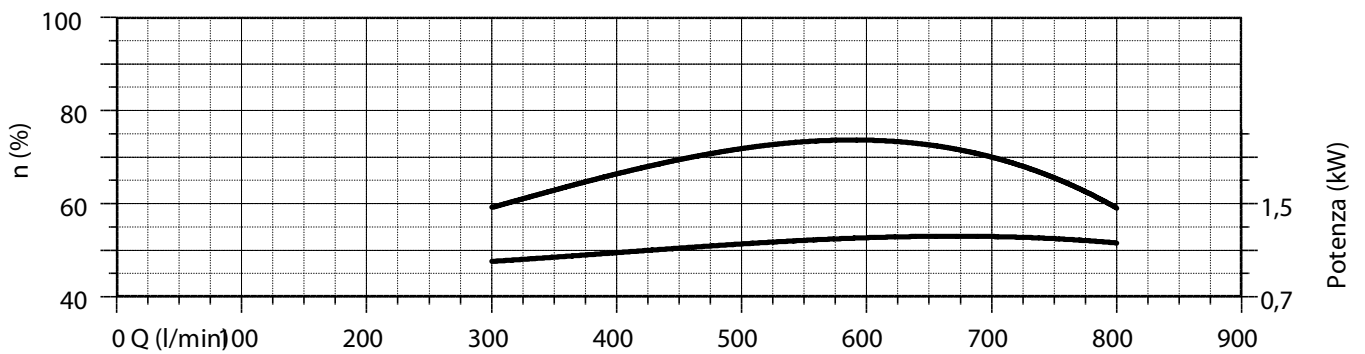
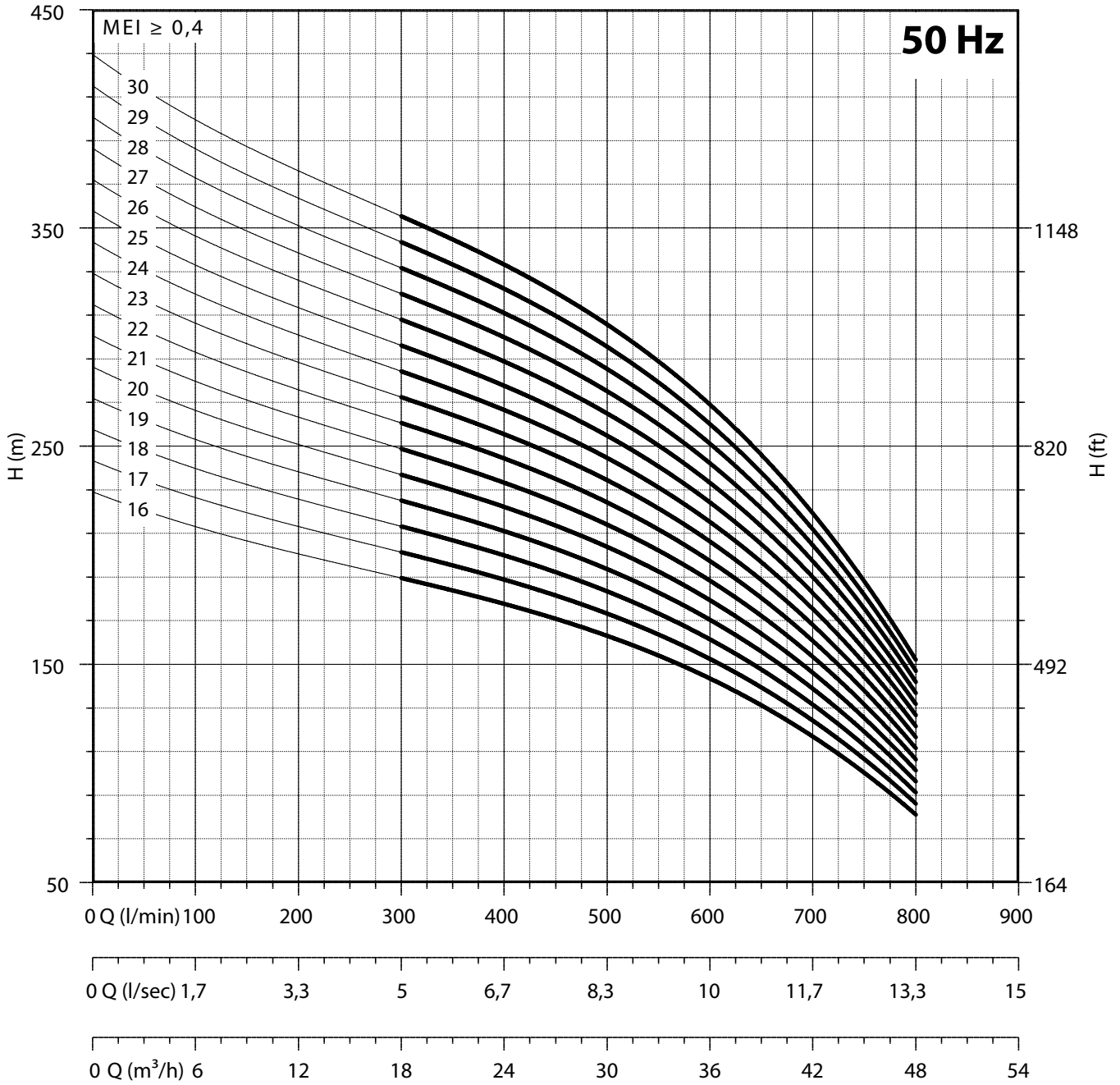

| NPSH (m) | 25% | 50% | 75% | 100% |
|------------|-----|-----|-----|------|
| 140 REC 34 | 3,4 | 3,4 | 3,8 | 8 |

CARATTERISTICHE IDRAULICHE - HYDRAULIC PERFORMANCES

Q= Portata - Capacity - Debit **50 Hz n= 2900 min**

| Tipo Type | Power | | H(m) | 0 | 400 | 500 | 600 | 700 | 800 | 900 | 1000 | |
|---------------|-------|------|------|-------|-------|-------------------|-------|-------|-------------------|-------|-------|-------------------|
| | kW | HP | | l/min | l/sec | m ³ /h | l/min | l/sec | m ³ /h | l/min | l/sec | m ³ /h |
| | | | | 0 | 6,67 | 8,33 | 10 | 11,67 | 13,33 | 15 | 16,67 | |
| 140 REC 44/3 | 4 | 5,5 | 40 | 32 | 31 | 29 | 26 | 22 | 17 | 10 | | |
| 140 REC 44/4 | 5,5 | 7,5 | 53 | 43 | 41 | 38 | 34 | 29 | 22 | 13 | | |
| 140 REC 44/5 | 7,5 | 10 | 67 | 53 | 51 | 48 | 43 | 36 | 28 | 17 | | |
| 140 REC 44/6 | 9,2 | 12,5 | 80 | 64 | 61 | 57 | 51 | 43 | 33 | 20 | | |
| 140 REC 44/7 | 9,2 | 12,5 | 93 | 75 | 71 | 67 | 60 | 50 | 39 | 23 | | |
| 140 REC 44/8 | 11 | 15 | 107 | 85 | 81 | 76 | 68 | 57 | 44 | 27 | | |
| 140 REC 44/9 | 13 | 17,5 | 120 | 96 | 92 | 86 | 77 | 65 | 50 | 30 | | |
| 140 REC 44/10 | 13 | 17,5 | 133 | 107 | 102 | 95 | 85 | 72 | 55 | 33 | | |
| 140 REC 44/11 | 15 | 20 | 147 | 117 | 112 | 105 | 94 | 79 | 61 | 37 | | |
| 140 REC 44/12 | 15 | 20 | 160 | 128 | 122 | 114 | 102 | 86 | 66 | 40 | | |
| 140 REC 44/13 | 18,5 | 25 | 173 | 139 | 132 | 124 | 111 | 93 | 72 | 43 | | |
| 140 REC 44/14 | 18,5 | 25 | 187 | 149 | 142 | 133 | 119 | 100 | 77 | 47 | | |
| 140 REC 44/15 | 22 | 30 | 200 | 160 | 153 | 143 | 128 | 108 | 83 | 50 | | |

DIMENSIONI D'INGOMBRO E PESI - OVERALL DIMENSIONS AND WEIGHTS

| Type | A mm Tri V 400 | B mm | C mm Tri | M Kg Tri | P Kg |
|---------------|-------------------|------|----------|----------|------|
| 140 REC 44/3 | 1242 | 596 | 646 | 40 | 19 |
| 140 REC 44/4 | 1368 | 697 | 671 | 45 | 23 |
| 140 REC 44/5 | 1499 | 798 | 701 | 55 | 28 |
| 140 REC 44/6 | 1650 | 899 | 751 | 60 | 32 |
| 140 REC 44/7 | 1751 | 1000 | 751 | 60 | 36 |
| 140 REC 44/8 | 1912 | 1101 | 811 | 65 | 40 |
| 140 REC 44/9 | 2043 | 1202 | 841 | 70 | 44 |
| 140 REC 44/10 | 2144 | 1303 | 841 | 70 | 48 |
| 140 REC 44/11 | 2335 | 1404 | 931 | 75 | 52 |
| 140 REC 44/12 | 2436 | 1505 | 931 | 75 | 56 |
| 140 REC 44/13 | 2597 | 1606 | 991 | 83 | 60 |
| 140 REC 44/14 | 2698 | 1707 | 991 | 83 | 64 |
| 140 REC 44/15 | 2879 | 1808 | 1071 | 92 | 69 |

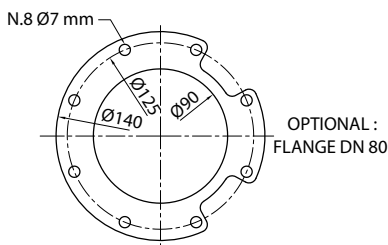
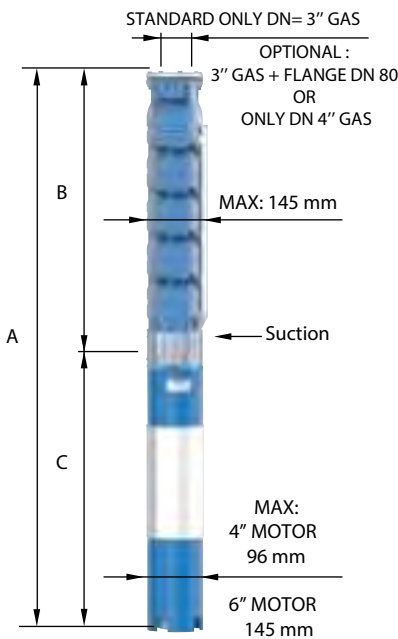

FOR COMMERCIAL PIPE
EXTERNAL DIAMETER: 88,9 mm

n% = Rendimento della pompa
n% = Rendement de la pompe
n% = Pump efficiency
n% = Rendimiento de la bomba

**Max
74%**

kW/st = Assorbimento per stadio
kW/st = Absorption par étage
kW/st = Stage absorption
kW/st = Potencia absorbida por etapa

**Max
1,32**

Tolleranza alla sabbia 50 g/m³ - Sand tolerance 50 g/m³
Tolleranze secondo UNI ISO 9906 livello 3B - Tolerances according to UNI ISO 9906 grade 3B

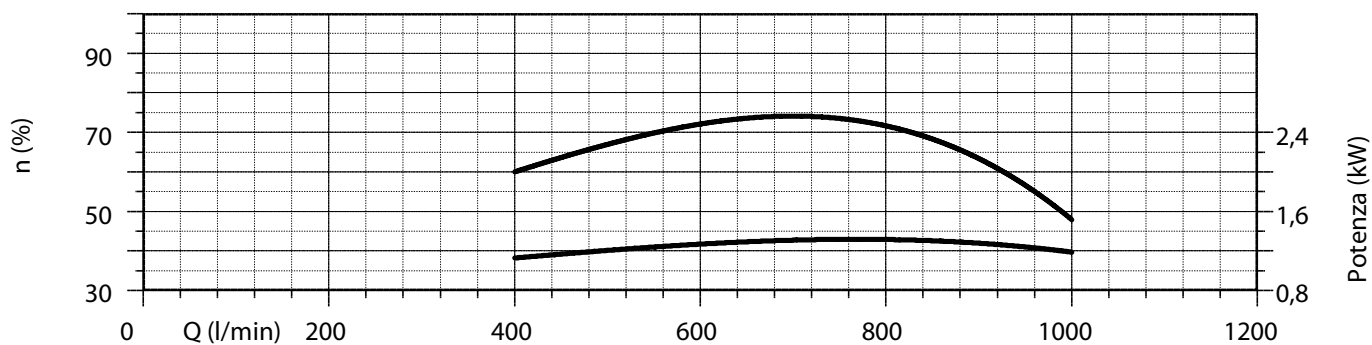
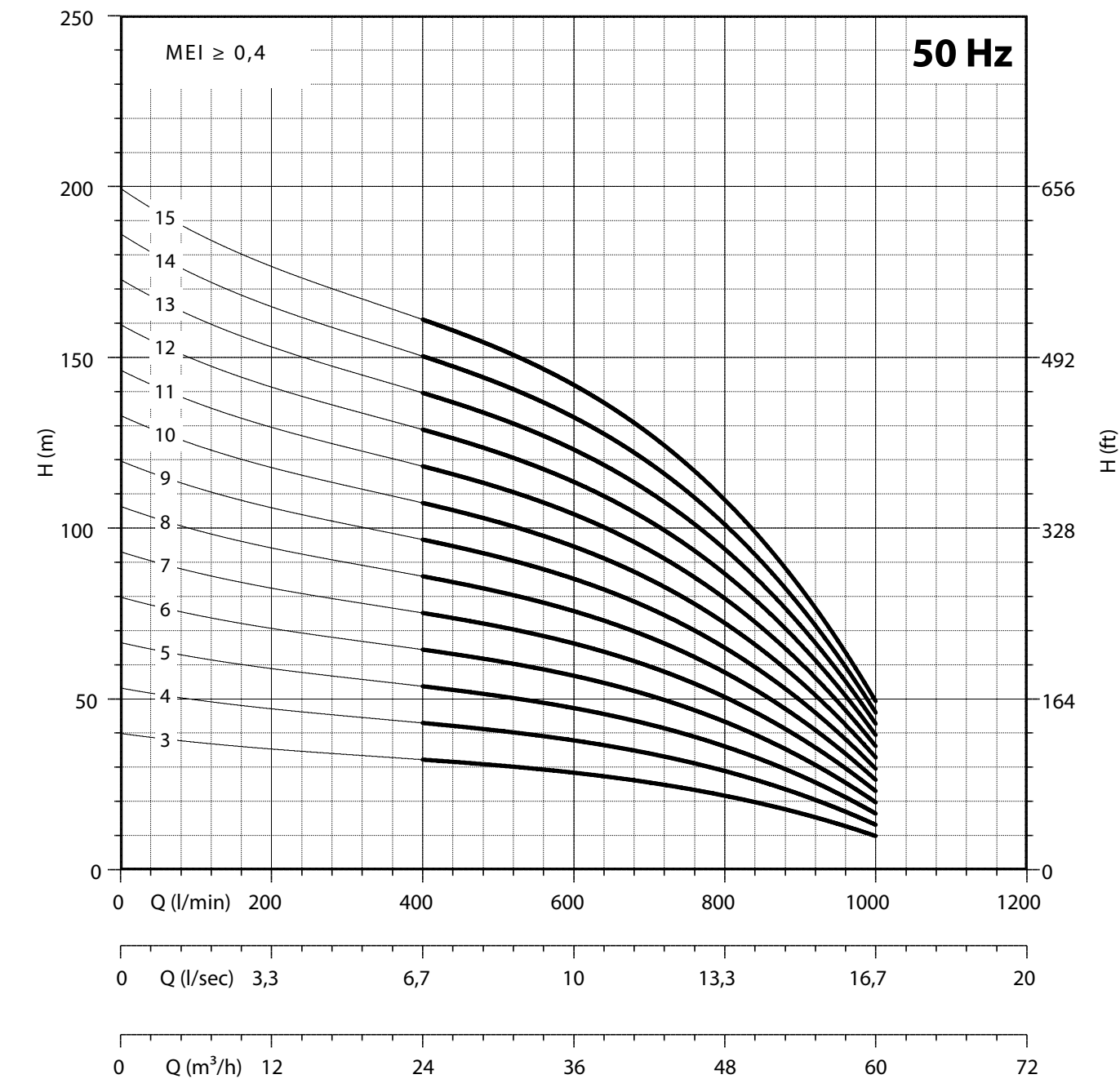

| NPSH (m) | 25% | 50% | 75% | 100% |
|------------|------|-----|-----|------|
| 140 REC 44 | 3,45 | 3,5 | 3,8 | 5 |

CARATTERISTICHE IDRAULICHE - HYDRAULIC PERFORMANCES

Q= Portata - Capacity - Debit **50 Hz n= 2900 min**

| Tipo Type | Power | | H(m) | 0 | 400 | 500 | 600 | 700 | 800 | 900 | 1000 | |
|---------------|-------|----|------|-------|-------|-------------------|-------|-------|-------------------|-------|-------|-------------------|
| | kW | HP | | l/min | l/sec | m ³ /h | l/min | l/sec | m ³ /h | l/min | l/sec | m ³ /h |
| | | | | 0 | 6,67 | 8,33 | 10 | 11,67 | 13,33 | 15 | 16,67 | |
| 140 REC 44/16 | 22 | 30 | | 213 | 171 | 163 | 152 | 136 | 115 | 88 | 53 | |
| 140 REC 44/17 | 22 | 30 | | 227 | 181 | 173 | 162 | 145 | 122 | 94 | 57 | |
| 140 REC 44/18 | 26 | 35 | | 240 | 192 | 183 | 171 | 153 | 129 | 99 | 60 | |
| 140 REC 44/19 | 26 | 35 | | 253 | 203 | 193 | 181 | 162 | 136 | 105 | 63 | |
| 140 REC 44/20 | 26 | 35 | | 267 | 213 | 203 | 190 | 170 | 143 | 110 | 67 | |
| 140 REC 44/21 | 30 | 40 | | 280 | 224 | 214 | 200 | 179 | 151 | 116 | 70 | |
| 140 REC 44/22 | 30 | 40 | | 293 | 235 | 224 | 209 | 187 | 158 | 121 | 73 | |
| 140 REC 44/23 | 30 | 40 | | 307 | 245 | 234 | 219 | 196 | 165 | 127 | 77 | |
| 140 REC 44/24 | 37 | 50 | | 320 | 256 | 244 | 228 | 204 | 172 | 132 | 80 | |
| 140 REC 44/25 | 37 | 50 | | 333 | 267 | 254 | 238 | 213 | 179 | 138 | 83 | |
| 140 REC 44/26 | 37 | 50 | | 347 | 277 | 264 | 247 | 221 | 186 | 143 | 87 | |
| 140 REC 44/27 | 37 | 50 | | 360 | 288 | 275 | 257 | 230 | 194 | 149 | 90 | |
| 140 REC 44/28 | 37 | 50 | | 373 | 299 | 285 | 266 | 238 | 201 | 154 | 93 | |

DIMENSIONI D'INGOMBRO E PESI - OVERALL DIMENSIONS AND WEIGHTS

| Type | A mm Tri V 400 | B mm | C mm Tri | M Kg Tri | P Kg |
|---------------|-------------------|------|----------|----------|------|
| 140 REC 44/16 | 2980 | 1909 | 1071 | 92 | 73 |
| 140 REC 44/17 | 3081 | 2010 | 1071 | 92 | 77 |
| 140 REC 44/18 | 3292 | 2111 | 1181 | 100 | 81 |
| 140 REC 44/19 | 3393 | 2212 | 1181 | 100 | 85 |
| 140 REC 44/20 | 3494 | 2313 | 1181 | 100 | 89 |
| 140 REC 44/21 | 3665 | 2414 | 1251 | 108 | 93 |
| 140 REC 44/22 | 3766 | 2515 | 1251 | 108 | 97 |
| 140 REC 44/23 | 3867 | 2616 | 1251 | 108 | 101 |
| 140 REC 44/24 | 4058 | 2717 | 1341 | 118 | 105 |
| 140 REC 44/25 | 4159 | 2818 | 1341 | 118 | 110 |
| 140 REC 44/26 | 4260 | 2919 | 1341 | 118 | 114 |
| 140 REC 44/27 | 4361 | 3020 | 1341 | 118 | 118 |
| 140 REC 44/28 | 4462 | 3121 | 1341 | 118 | 122 |

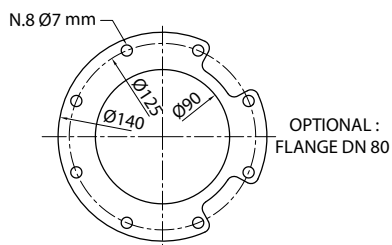
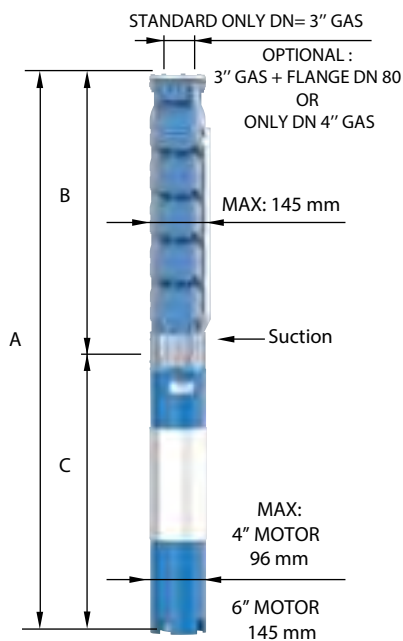

FOR COMMERCIAL PIPE
EXTERNAL DIAMETER: 88,9 mm

n% = Rendimento della pompa
n% = Rendement de la pompe
n% = Pump efficiency
n% = Rendimiento de la bomba

**Max
74%**

kW/st = Assorbimento per stadio
kW/st = Absorption par étage
kW/st = Stage absorption
kW/st = Potencia absorbida por etapa

**Max
1,32**

Tolleranza alla sabbia 50 g/m³ - Sand tolerance 50 g/m³
Tolleranze secondo UNI ISO 9906 livello 3B - Tolerances according to UNI ISO 9906 grade 3B

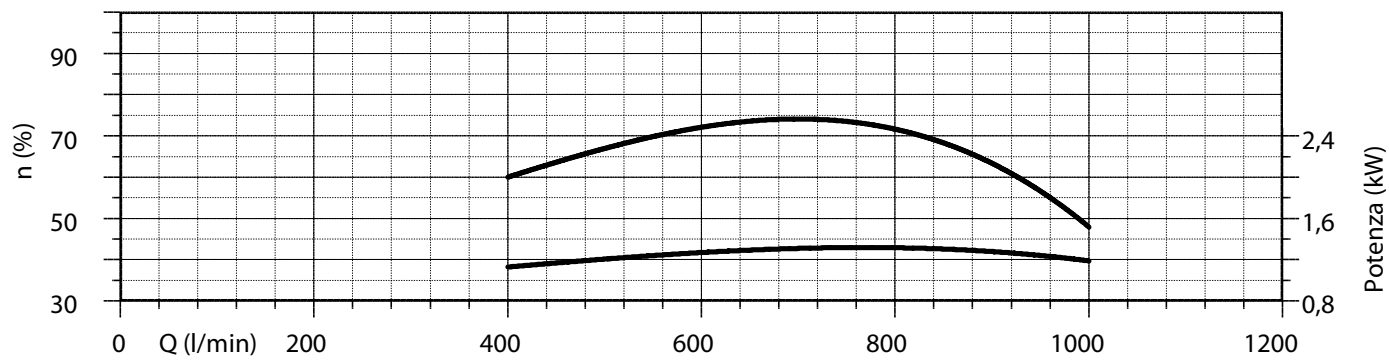
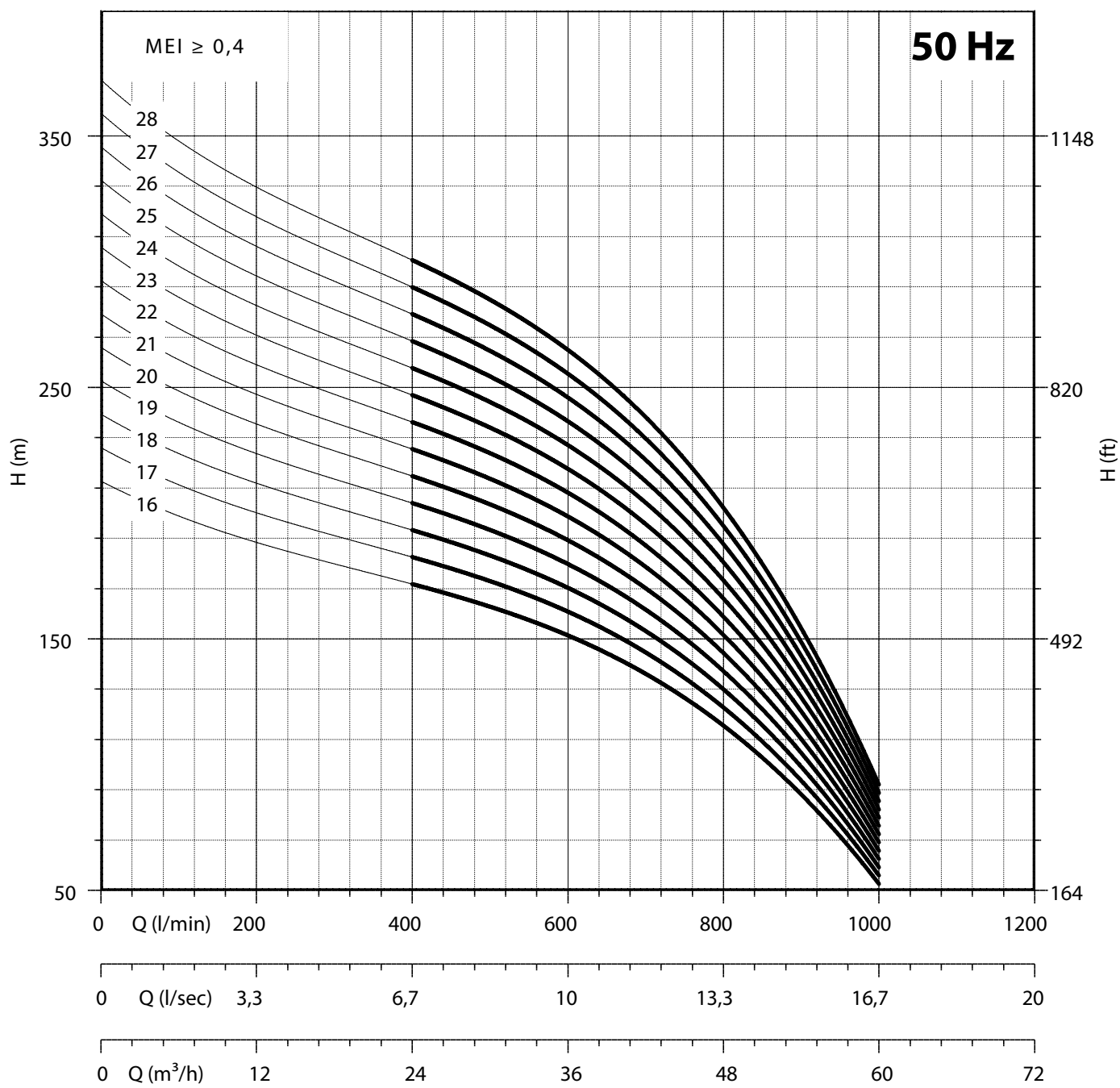

| NPSH (m) | 25% | 50% | 75% | 100% |
|------------|------|-----|-----|------|
| 140 REC 44 | 3,45 | 3,5 | 3,8 | 5 |

CARATTERISTICHE IDRAULICHE - HYDRAULIC PERFORMANCES

Q= Portata - Capacity - Debit

50 Hz n= 2900 min

| Tipo Type | Power | | H(m) | l/min | 500 | 600 | 800 | 1000 | 1200 |
|---------------|-------|------|------|-------------------|------|-----|-------|-------|------|
| | kW | HP | | l/sec | 8,33 | 10 | 13,33 | 16,67 | 20 |
| | | | | m ³ /h | 30 | 36 | 48 | 60 | 72 |
| 140 REC 54/3 | 5,5 | 7,5 | | 39 | 30 | 28 | 24 | 18 | 8 |
| 140 REC 54/4 | 7,5 | 10 | | 52 | 40 | 38 | 32 | 24 | 10 |
| 140 REC 54/5 | 7,5 | 10 | | 65 | 50 | 47 | 40 | 30 | 13 |
| 140 REC 54/6 | 9,2 | 12,5 | | 78 | 60 | 56 | 48 | 35 | 16 |
| 140 REC 54/7 | 11 | 15 | | 91 | 70 | 66 | 56 | 41 | 18 |
| 140 REC 54/8 | 13 | 17,5 | | 104 | 80 | 75 | 64 | 47 | 21 |
| 140 REC 54/9 | 13 | 17,5 | | 117 | 90 | 85 | 72 | 53 | 23 |
| 140 REC 54/10 | 15 | 20 | | 130 | 100 | 94 | 80 | 59 | 26 |
| 140 REC 54/11 | 18,5 | 25 | | 143 | 110 | 103 | 87 | 65 | 29 |
| 140 REC 54/12 | 18,5 | 25 | | 156 | 120 | 113 | 95 | 71 | 31 |
| 140 REC 54/13 | 18,5 | 25 | | 169 | 130 | 122 | 103 | 77 | 34 |
| 140 REC 54/14 | 22 | 30 | | 182 | 140 | 132 | 111 | 83 | 36 |
| 140 REC 54/15 | 22 | 30 | | 195 | 150 | 141 | 119 | 89 | 39 |
| 140 REC 54/16 | 26 | 35 | | 208 | 160 | 150 | 127 | 94 | 42 |
| 140 REC 54/17 | 26 | 35 | | 221 | 170 | 160 | 135 | 100 | 44 |
| 140 REC 54/18 | 26 | 35 | | 234 | 180 | 169 | 143 | 106 | 47 |
| 140 REC 54/19 | 30 | 40 | | 247 | 190 | 179 | 151 | 112 | 49 |
| 140 REC 54/20 | 30 | 40 | | 260 | 200 | 188 | 159 | 118 | 52 |
| 140 REC 54/21 | 30 | 40 | | 273 | 210 | 197 | 167 | 124 | 55 |
| 140 REC 54/22 | 37 | 50 | | 286 | 220 | 207 | 175 | 130 | 57 |
| 140 REC 54/23 | 37 | 50 | | 299 | 230 | 216 | 183 | 136 | 60 |
| 140 REC 54/24 | 37 | 50 | | 312 | 240 | 226 | 191 | 142 | 62 |
| 140 REC 54/25 | 37 | 50 | | 325 | 250 | 235 | 199 | 148 | 65 |

DIMENSIONI D'INGOMBRO E PESI - OVERALL DIMENSIONS AND WEIGHTS

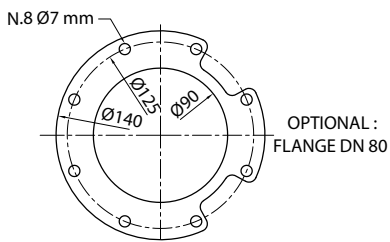
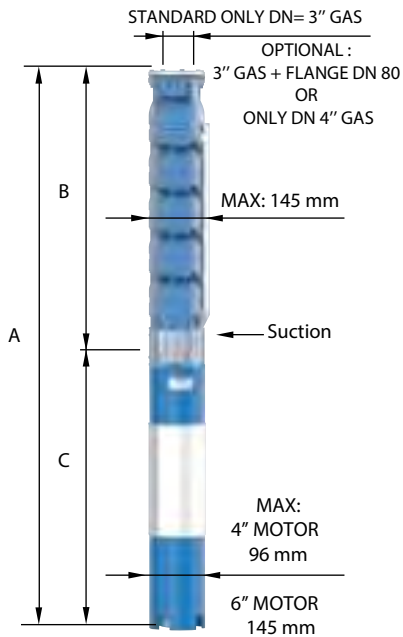

FOR COMMERCIAL PIPE
EXTERNAL DIAMETER: 88,9 mm

| Type | A mm Tri V 400 | B mm | C mm Tri | M Kg Tri | P Kg |
|---------------|-------------------|------|----------|----------|------|
| 140 REC 54/3 | 1285 | 614 | 671 | 45 | 21 |
| 140 REC 54/4 | 1422 | 721 | 701 | 55 | 25 |
| 140 REC 54/5 | 1529 | 828 | 701 | 55 | 30 |
| 140 REC 54/6 | 1686 | 935 | 751 | 60 | 34 |
| 140 REC 54/7 | 1853 | 1042 | 811 | 65 | 39 |
| 140 REC 54/8 | 1990 | 1149 | 841 | 70 | 43 |
| 140 REC 54/9 | 2097 | 1256 | 841 | 70 | 48 |
| 140 REC 54/10 | 2294 | 1363 | 931 | 75 | 52 |
| 140 REC 54/11 | 2461 | 1470 | 991 | 83 | 57 |
| 140 REC 54/12 | 2568 | 1577 | 991 | 83 | 61 |
| 140 REC 54/13 | 2675 | 1684 | 991 | 83 | 66 |
| 140 REC 54/14 | 2862 | 1791 | 1071 | 92 | 70 |
| 140 REC 54/15 | 2969 | 1898 | 1071 | 92 | 75 |
| 140 REC 54/16 | 3186 | 2005 | 1181 | 100 | 79 |
| 140 REC 54/17 | 3293 | 2112 | 1181 | 100 | 84 |
| 140 REC 54/18 | 3400 | 2219 | 1181 | 100 | 88 |
| 140 REC 54/19 | 3577 | 2326 | 1251 | 108 | 93 |
| 140 REC 54/20 | 3684 | 2433 | 1251 | 108 | 97 |
| 140 REC 54/21 | 3791 | 2540 | 1251 | 108 | 102 |
| 140 REC 54/22 | 3988 | 2647 | 1341 | 118 | 106 |
| 140 REC 54/23 | 4095 | 2754 | 1341 | 118 | 111 |
| 140 REC 54/24 | 4202 | 2861 | 1341 | 118 | 115 |
| 140 REC 54/25 | 4309 | 2968 | 1341 | 118 | 120 |

n% = Rendimento della pompa
n% = Rendement de la pompe
n% = Pump efficiency
n% = Rendimiento de la bomba

Max
73,6%

kW/st = Assorbimento per stadio
kW/st = Absorption par étage
kW/st = Stage absorption
kW/st = Potencia absorbida por etapa

Max
1,44

Tolleranza alla sabbia 50 g/m³ - Sand tolerance 50 g/m³

Tolleranze secondo UNI ISO 9906 livello 3B - Tolerances according to UNI ISO 9906 grade 3B

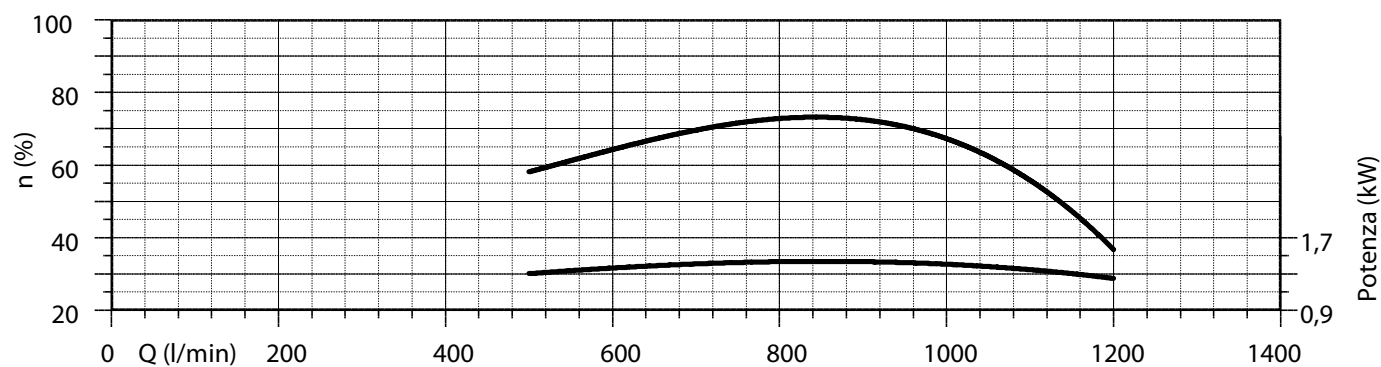
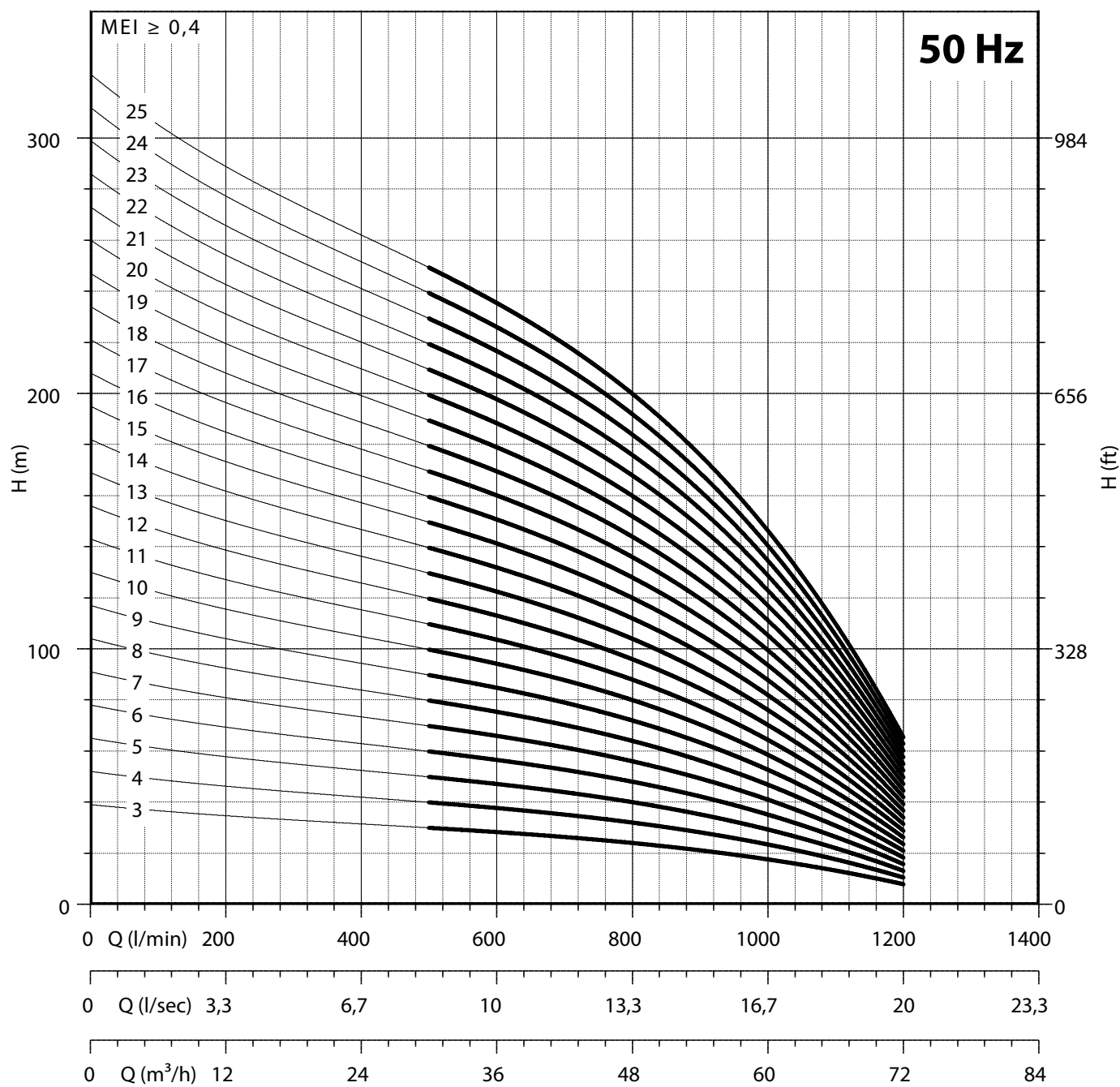

| NPSH (m) | 25% | 50% | 75% | 100% |
|------------|-----|-----|-----|------|
| 140 REC 54 | 3,8 | 3,8 | 5,1 | 7,1 |

CARATTERISTICHE IDRAULICHE - HYDRAULIC PERFORMANCES

Q= Portata - Capacity - Debit 50 Hz n= 2900 min

| Tipo Type | Power | | H(m) | 0 | 600 | 800 | 1000 | 1200 | 1400 |
|---------------|-------|------|------|-------|-------|-------------------|-------|-------|-------------------|
| | kW | HP | | l/min | l/sec | m ³ /h | l/min | l/sec | m ³ /h |
| | | | | 0 | 10 | 13,33 | 16,67 | 20 | 23,33 |
| 140 REC 66/3 | 5,5 | 7,5 | 39 | 29 | 26 | 23 | 17 | 6 | |
| 140 REC 66/4 | 7,5 | 10 | 52 | 39 | 35 | 31 | 23 | 8 | |
| 140 REC 66/5 | 9,2 | 12,5 | 65 | 49 | 44 | 39 | 29 | 10 | |
| 140 REC 66/6 | 11 | 15 | 78 | 59 | 53 | 47 | 34 | 12 | |
| 140 REC 66/7 | 13 | 17,5 | 91 | 69 | 62 | 55 | 40 | 14 | |
| 140 REC 66/8 | 15 | 20 | 104 | 78 | 70 | 62 | 46 | 16 | |
| 140 REC 66/9 | 15 | 20 | 117 | 88 | 79 | 70 | 51 | 18 | |
| 140 REC 66/10 | 18,5 | 25 | 130 | 98 | 88 | 78 | 57 | 20 | |
| 140 REC 66/11 | 22 | 30 | 143 | 108 | 97 | 86 | 63 | 22 | |
| 140 REC 66/12 | 22 | 30 | 156 | 118 | 106 | 94 | 68 | 24 | |
| 140 REC 66/13 | 22 | 30 | 169 | 127 | 114 | 101 | 74 | 26 | |
| 140 REC 66/14 | 26 | 35 | 182 | 137 | 123 | 109 | 80 | 28 | |
| 140 REC 66/15 | 26 | 35 | 195 | 147 | 132 | 117 | 86 | 30 | |
| 140 REC 66/16 | 30 | 40 | 208 | 157 | 141 | 125 | 91 | 32 | |
| 140 REC 66/17 | 30 | 40 | 221 | 167 | 150 | 133 | 97 | 34 | |
| 140 REC 66/18 | 37 | 50 | 234 | 176 | 158 | 140 | 103 | 36 | |
| 140 REC 66/19 | 37 | 50 | 247 | 186 | 167 | 148 | 108 | 38 | |
| 140 REC 66/20 | 37 | 50 | 260 | 196 | 176 | 156 | 114 | 40 | |
| 140 REC 66/21 | 37 | 50 | 273 | 206 | 185 | 164 | 120 | 42 | |

DIMENSIONI D'INGOMBRO E PESI - OVERALL DIMENSIONS AND WEIGHTS

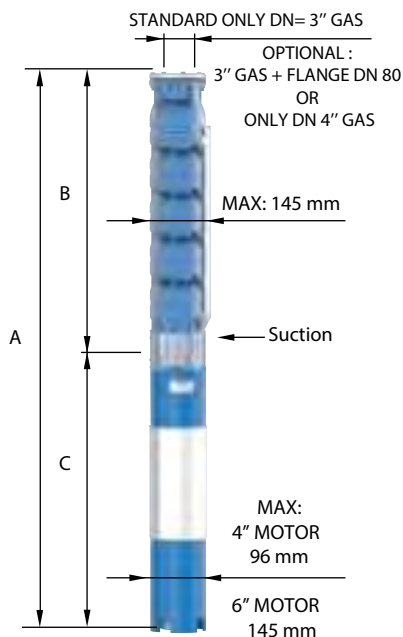

| Type | A mm Tri V 400 | B mm | C mm Tri | M Kg Tri | P Kg |
|---------------|-------------------|------|----------|----------|------|
| 140 REC 66/3 | 1285 | 614 | 671 | 45 | 21 |
| 140 REC 66/4 | 1422 | 721 | 701 | 55 | 25 |
| 140 REC 66/5 | 1579 | 828 | 751 | 60 | 30 |
| 140 REC 66/6 | 1746 | 935 | 811 | 65 | 34 |
| 140 REC 66/7 | 1883 | 1042 | 841 | 70 | 39 |
| 140 REC 66/8 | 2080 | 1149 | 931 | 75 | 43 |
| 140 REC 66/9 | 2187 | 1256 | 931 | 75 | 48 |
| 140 REC 66/10 | 2354 | 1363 | 991 | 83 | 52 |
| 140 REC 66/11 | 2541 | 1470 | 1071 | 92 | 57 |
| 140 REC 66/12 | 2648 | 1577 | 1071 | 92 | 61 |
| 140 REC 66/13 | 2755 | 1684 | 1071 | 92 | 66 |
| 140 REC 66/14 | 2972 | 1791 | 1181 | 100 | 70 |
| 140 REC 66/15 | 3079 | 1898 | 1181 | 100 | 75 |
| 140 REC 66/16 | 3256 | 2005 | 1251 | 108 | 79 |
| 140 REC 66/17 | 3363 | 2112 | 1251 | 108 | 84 |
| 140 REC 66/18 | 3560 | 2219 | 1341 | 118 | 88 |
| 140 REC 66/19 | 3667 | 2326 | 1341 | 118 | 93 |
| 140 REC 66/20 | 3774 | 2433 | 1341 | 118 | 97 |
| 140 REC 66/21 | 3881 | 2540 | 1341 | 118 | 102 |

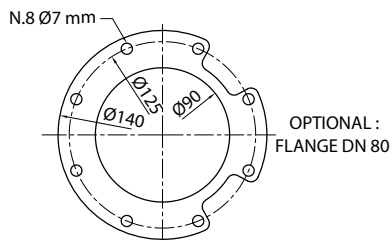

FOR COMMERCIAL PIPE
EXTERNAL DIAMETER: 88,9 mm

n% = Rendimento della pompa
n% = Rendement de la pompe
n% = Pump efficiency
n% = Rendimiento de la bomba

Max
74%

kW/st = Assorbimento per stadio
kW/st = Absorption par étage
kW/st = Stage absorption
kW/st = Potencia absorbida por etapa

Max
1,74

Tolleranza alla sabbia 50 g/m³ - Sand tolerance 50 g/m³
Tolleranze secondo UNI ISO 9906 livello 3B - Tolerances according to UNI ISO 9906 grade 3B

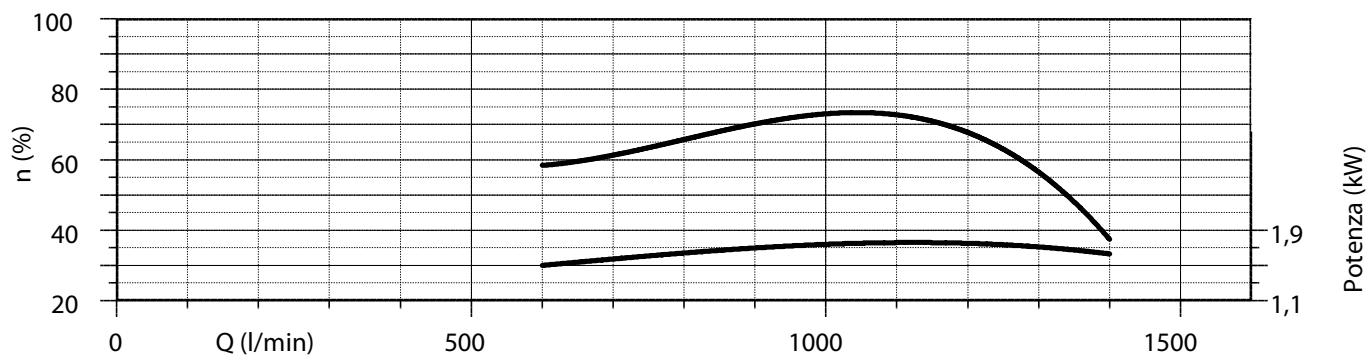
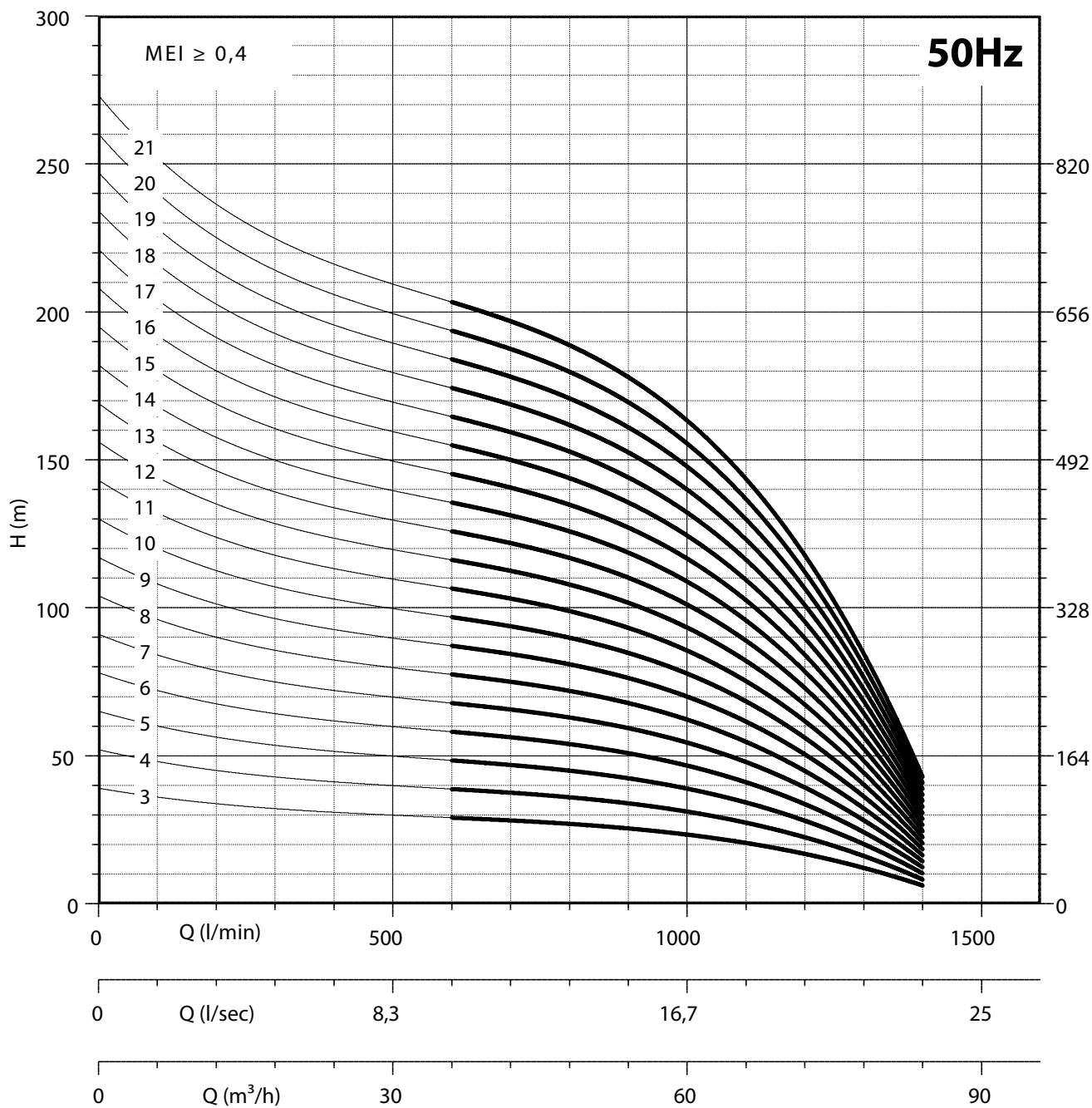

| NPSH (m) | 25% | 50% | 75% | 100% |
|------------|-----|-----|-----|------|
| 140 REC 66 | 3,8 | 3,8 | 5,1 | 7,1 |

CARATTERISTICHE IDRAULICHE - HYDRAULIC PERFORMANCES

Q= Portata - Capacity - Debit **50 Hz n= 2900 min**

| Tipo Type | Power | | H(m) | 0 | 600 | 800 | 1000 | 1200 | 1400 | 1600 | | |
|---------------|-------|-----|------|-------|-------|-------------------|-------|-------|-------------------|-------|-------|-------------------|
| | kW | HP | | l/min | l/sec | m ³ /h | l/min | l/sec | m ³ /h | l/min | l/sec | m ³ /h |
| | | | | 0 | 10 | 13,33 | 16,67 | 20 | 23,33 | 26,67 | | |
| 180 REC 78/1 | 5,5 | 7,5 | 26 | 22 | 21 | 19 | 18 | 15 | 11 | | | |
| 180 REC 78/2 | 11 | 15 | 53 | 45 | 42 | 39 | 35 | 30 | 23 | | | |
| 180 REC 78/3 | 15 | 20 | 79 | 67 | 63 | 58 | 53 | 44 | 34 | | | |
| 180 REC 78/4 | 22 | 30 | 105 | 89 | 84 | 78 | 70 | 59 | 45 | | | |
| 180 REC 78/5 | 26 | 35 | 131 | 111 | 105 | 97 | 88 | 74 | 56 | | | |
| 180 REC 78/6 | 30 | 40 | 158 | 134 | 126 | 116 | 105 | 89 | 68 | | | |
| 180 REC 78/7 | 37 | 50 | 184 | 156 | 147 | 136 | 123 | 103 | 79 | | | |
| 180 REC 78/8 | 44 | 60 | 210 | 178 | 168 | 155 | 140 | 118 | 90 | | | |
| 180 REC 78/9 | 44 | 60 | 236 | 200 | 189 | 174 | 158 | 133 | 101 | | | |
| 180 REC 78/10 | 55 | 75 | 263 | 223 | 210 | 194 | 175 | 148 | 113 | | | |
| 180 REC 78/11 | 55 | 75 | 289 | 245 | 231 | 213 | 193 | 162 | 124 | | | |
| 180 REC 78/12 | 66 | 90 | 315 | 267 | 252 | 233 | 210 | 177 | 135 | | | |
| 180 REC 78/13 | 66 | 90 | 341 | 289 | 273 | 252 | 228 | 192 | 146 | | | |
| 180 REC 78/14 | 75 | 100 | 368 | 312 | 294 | 271 | 245 | 207 | 158 | | | |
| 180 REC 78/15 | 75 | 100 | 394 | 334 | 315 | 291 | 263 | 221 | 169 | | | |

DIMENSIONI D'INGOMBRO E PESI - OVERALL DIMENSIONS AND WEIGHTS

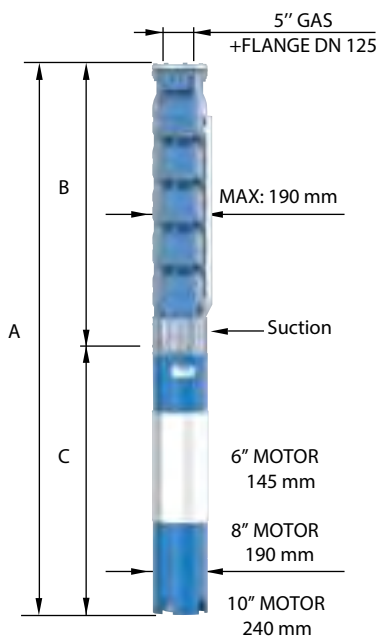

| Type | A mm Tri V 400 | B mm | C mm Tri | M Kg Tri | P Kg |
|---------------|-------------------|------|----------|----------|------|
| 180 REC 78/1 | 1225 | 527 | 671 | 45 | 23 |
| 180 REC 78/2 | 1463 | 652 | 811 | 65 | 31 |
| 180 REC 78/3 | 1708 | 777 | 931 | 75 | 39 |
| 180 REC 78/4 | 1973 | 902 | 1071 | 92 | 48 |
| 180 REC 78/5 | 2208 | 1027 | 1181 | 100 | 56 |
| 180 REC 78/6 | 2403 | 1152 | 1251 | 108 | 64 |
| 180 REC 78/7 | 2618 | 1277 | 1341 | 118 | 73 |
| 180 REC 78/8 | 2525 | 1402 | 1123 | 178 | 81 |
| 180 REC 78/9 | 2650 | 1527 | 1123 | 178 | 89 |
| 180 REC 78/10 | 2885 | 1652 | 1233 | 200 | 98 |
| 180 REC 78/11 | 3010 | 1777 | 1233 | 200 | 106 |
| 180 REC 78/12 | 3205 | 1902 | 1303 | 214 | 114 |
| 180 REC 78/13 | 3330 | 2027 | 1303 | 214 | 122 |
| 180 REC 78/14 | 3535 | 2152 | 1383 | 230 | 131 |
| 180 REC 78/15 | 3660 | 2277 | 1383 | 230 | 139 |

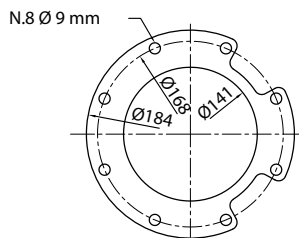

FOR COMMERCIAL PIPE
EXTERNAL DIAMETER: 139,7 mm

n% = Rendimento della pompa
n% = Rendement de la pompe
n% = Pump efficiency
n% = Rendimiento de la bomba

**Max
70%**

kW/st = Assorbimento per stadio
kW/st = Absorption par étage
kW/st = Stage absorption
kW/st = Potencia absorbida por etapa

**Max
5,1**

Tolleranza alla sabbia 50 g/m³ - Sand tolerance 50 g/m³
Tolleranze secondo UNI ISO 9906 livello 3B - Tolerances according to UNI ISO 9906 grade 3B

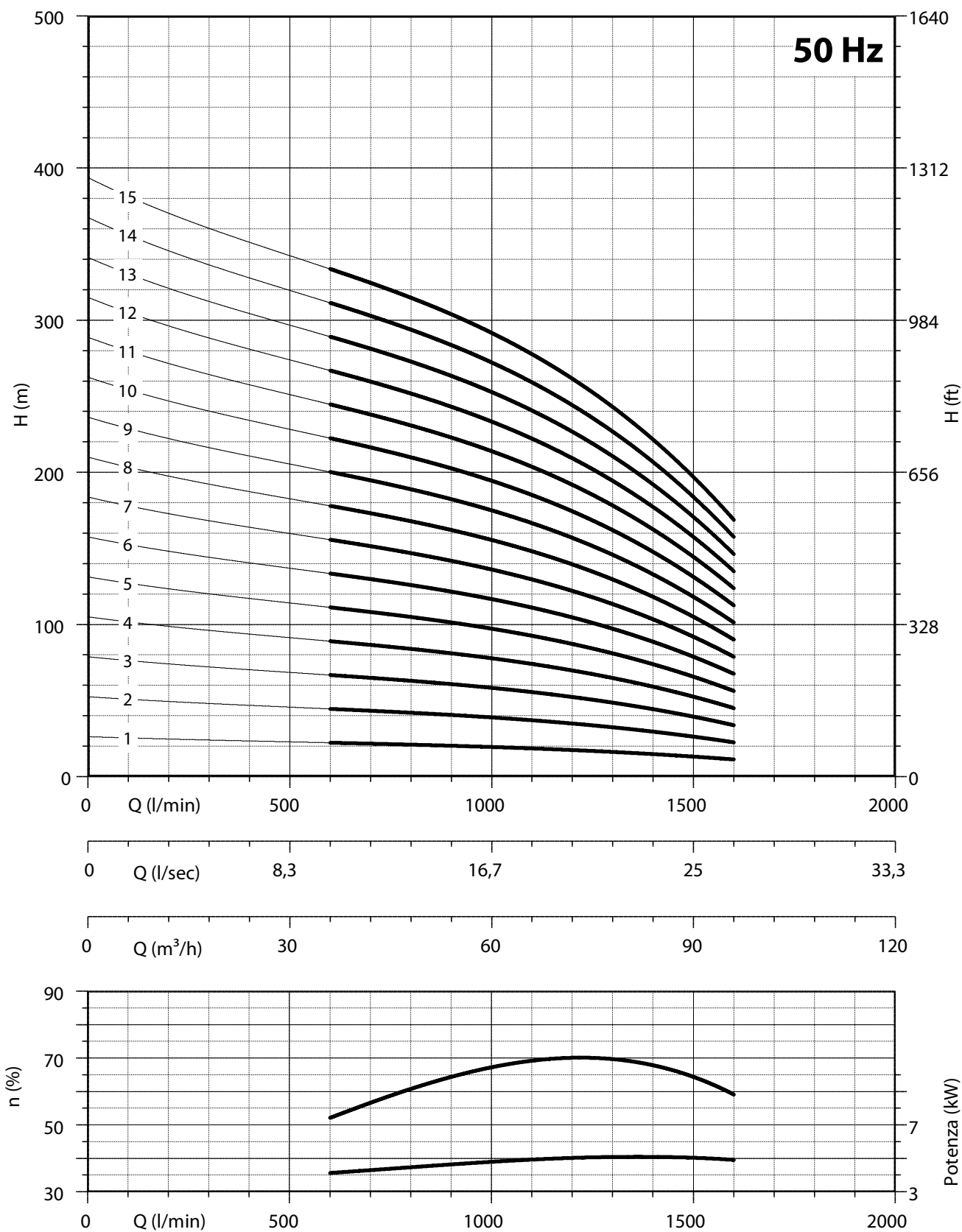

| NPSH (m) | 25% | 50% | 75% | 100% |
|------------|-----|-----|-----|------|
| 180 REC 78 | 3 | 3 | 3,5 | 4,5 |

CARATTERISTICHE IDRAULICHE - HYDRAULIC PERFORMANCES

Q= Portata - Capacity - Debit **50 Hz n= 2900 min**

| Tipo Type | Power | | H(m) | 0 | 800 | 1000 | 1200 | 1400 | 1600 | 1800 | 2000 | |
|---------------|-------|------|------|-------|-------|-------------------|-------|-------|-------------------|-------|-------|-------------------|
| | kW | HP | | l/min | l/sec | m ³ /h | l/min | l/sec | m ³ /h | l/min | l/sec | m ³ /h |
| | | | | 0 | 13,33 | 16,67 | 20 | 23,33 | 26,67 | 30 | 33,33 | |
| 180 REC 90/1 | 7,5 | 10 | 26 | 22 | 21 | 20 | 18 | 15 | 13 | 10 | | |
| 180 REC 90/2 | 13 | 17,5 | 53 | 44 | 42 | 39 | 35 | 31 | 25 | 20 | | |
| 180 REC 90/3 | 18,5 | 25 | 79 | 66 | 63 | 59 | 53 | 46 | 38 | 29 | | |
| 180 REC 90/4 | 26 | 35 | 105 | 89 | 84 | 78 | 70 | 61 | 50 | 39 | | |
| 180 REC 90/5 | 30 | 40 | 131 | 111 | 104 | 98 | 88 | 76 | 63 | 49 | | |
| 180 REC 90/6 | 37 | 50 | 158 | 133 | 125 | 117 | 105 | 92 | 75 | 59 | | |
| 180 REC 90/7 | 44 | 60 | 184 | 155 | 146 | 137 | 123 | 107 | 88 | 68 | | |
| 180 REC 90/8 | 55 | 75 | 210 | 177 | 167 | 156 | 140 | 122 | 100 | 78 | | |
| 180 REC 90/9 | 55 | 75 | 236 | 199 | 188 | 176 | 158 | 137 | 113 | 88 | | |
| 180 REC 90/10 | 66 | 90 | 263 | 221 | 209 | 195 | 175 | 153 | 125 | 98 | | |
| 180 REC 90/11 | 66 | 90 | 289 | 243 | 230 | 215 | 193 | 168 | 138 | 107 | | |
| 180 REC 90/12 | 75 | 100 | 315 | 266 | 251 | 234 | 210 | 183 | 150 | 117 | | |
| 180 REC 90/13 | 75 | 100 | 341 | 288 | 271 | 254 | 228 | 198 | 163 | 127 | | |
| 180 REC 90/14 | 92 | 125 | 368 | 310 | 292 | 273 | 245 | 214 | 175 | 137 | | |
| 180 REC 90/15 | 92 | 125 | 394 | 332 | 313 | 293 | 263 | 229 | 188 | 146 | | |

DIMENSIONI D'INGOMBRO E PESI - OVERALL DIMENSIONS AND WEIGHTS

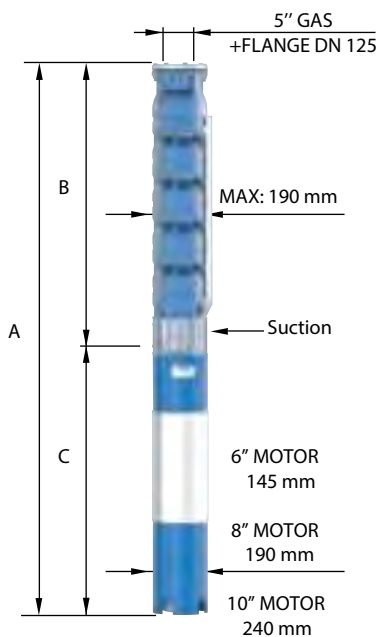

| Type | A mm Tri V 400 | B mm | C mm Tri | M Kg Tri | P Kg |
|---------------|-------------------|------|----------|----------|------|
| 180 REC 90/1 | 1228 | 527 | 701 | 55 | 23 |
| 180 REC 90/2 | 1493 | 652 | 841 | 70 | 31 |
| 180 REC 90/3 | 1768 | 777 | 991 | 83 | 39 |
| 180 REC 90/4 | 2083 | 902 | 1181 | 100 | 48 |
| 180 REC 90/5 | 2278 | 1027 | 1251 | 108 | 56 |
| 180 REC 90/6 | 2493 | 1152 | 1341 | 118 | 64 |
| 180 REC 90/7 | 2400 | 1277 | 1123 | 178 | 73 |
| 180 REC 90/8 | 2635 | 1402 | 1233 | 200 | 81 |
| 180 REC 90/9 | 2760 | 1527 | 1233 | 200 | 89 |
| 180 REC 90/10 | 2955 | 1652 | 1303 | 214 | 98 |
| 180 REC 90/11 | 3080 | 1777 | 1303 | 214 | 106 |
| 180 REC 90/12 | 3285 | 1902 | 1383 | 230 | 114 |
| 180 REC 90/13 | 3410 | 2027 | 1383 | 230 | 122 |
| 180 REC 90/14 | 3735 | 2152 | 1583 | 270 | 131 |
| 180 REC 90/15 | 3860 | 2277 | 1583 | 270 | 139 |

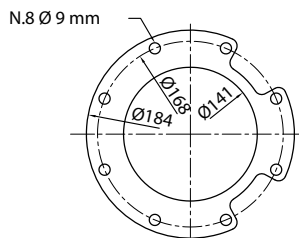

FOR COMMERCIAL PIPE
EXTERNAL DIAMETER: 139,7 mm

n% = Rendimento della pompa
n% = Rendement de la pompe
n% = Pump efficiency
n% = Rendimiento de la bomba

**Max
70%**

kW/st = Assorbimento per stadio
kW/st = Absorption par étage
kW/st = Stage absorption
kW/st = Potencia absorbida por etapa

**Max
5,9**

Tolleranza alla sabbia 50 g/m³ - Sand tolerance 50 g/m³
Tolleranze secondo UNI ISO 9906 livello 3B - Tolerances according to UNI ISO 9906 grade 3B

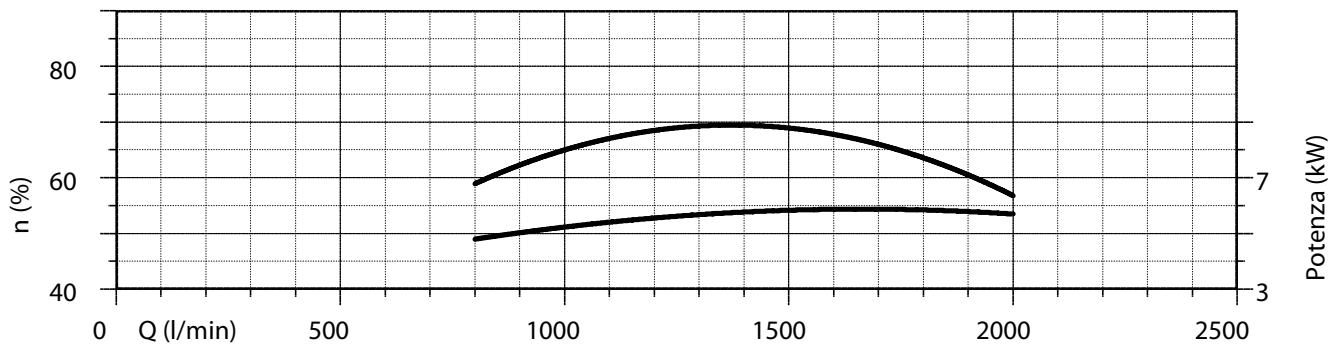
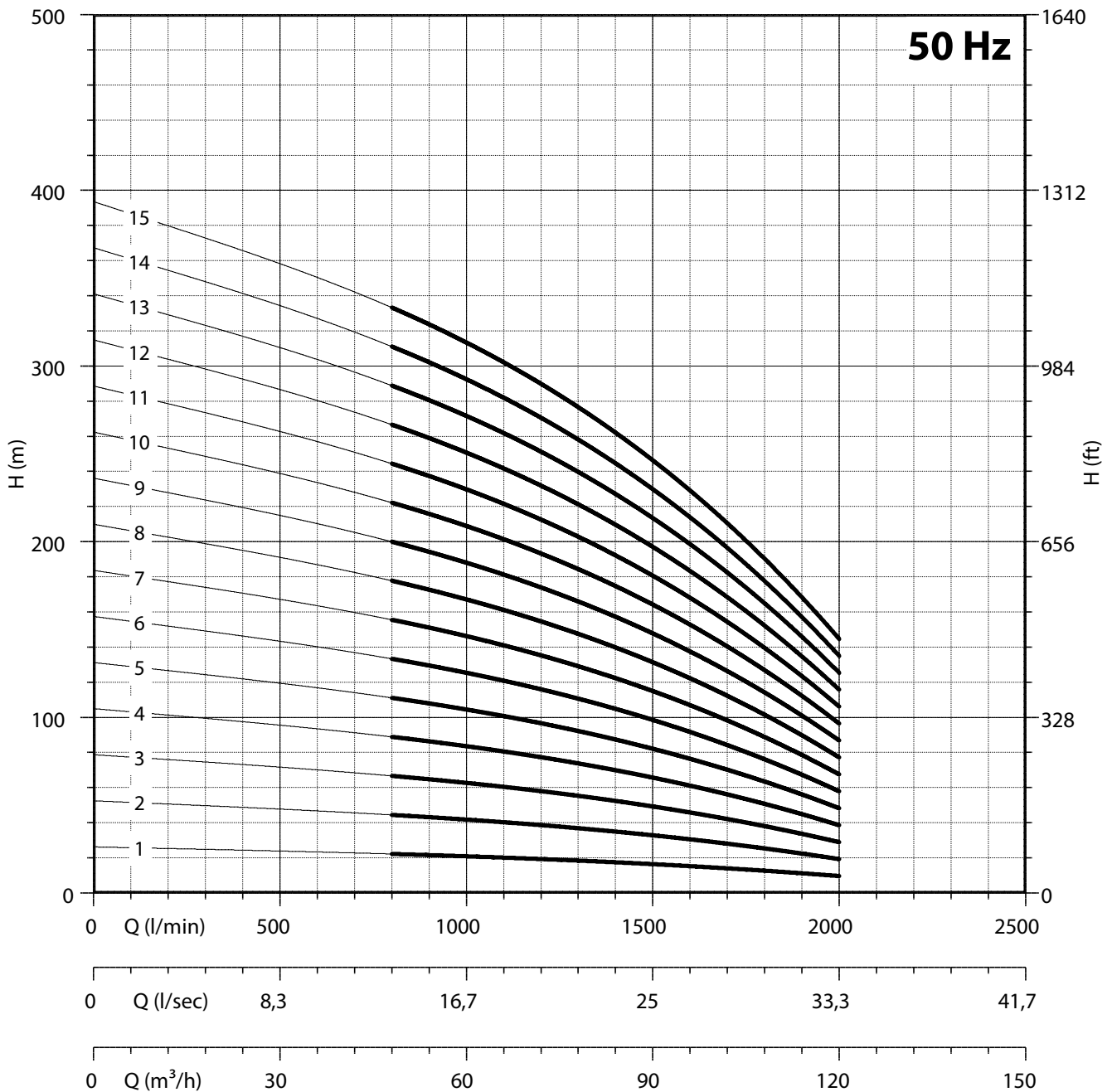

| NPSH (m) | 25% | 50% | 75% | 100% |
|------------|-----|-----|-----|------|
| 180 REC 90 | 3 | 4 | 5 | 8 |

CARATTERISTICHE IDRAULICHE - HYDRAULIC PERFORMANCES

Q= Portata - Capacity - Debit **50 Hz n= 2900 min**

| Tipo Type | Power | | H(m) | l/min | 0 | 1000 | 1200 | 1400 | 1600 | 1800 | 2000 | 2200 | 2400 |
|----------------|-------|-----|------|-------------------|-----|-------|------|-------|-------|------|-------|-------|------|
| | kW | HP | | l/sec | 0 | 16,67 | 20 | 23,33 | 26,67 | 30 | 33,33 | 36,67 | 40 |
| | | | | m ³ /h | 0 | 60 | 72 | 84 | 96 | 108 | 120 | 132 | 144 |
| 180 REC 102/1 | 7,5 | 10 | | 26 | 22 | 21 | 20 | 19 | 18 | 16 | 14 | 11 | |
| 180 REC 102/2 | 15 | 20 | | 53 | 44 | 42 | 40 | 38 | 35 | 32 | 28 | 22 | |
| 180 REC 102/3 | 22 | 30 | | 79 | 66 | 63 | 60 | 57 | 53 | 48 | 42 | 33 | |
| 180 REC 102/4 | 30 | 40 | | 105 | 87 | 84 | 80 | 76 | 71 | 65 | 55 | 45 | |
| 180 REC 102/5 | 37 | 50 | | 131 | 109 | 105 | 100 | 95 | 89 | 81 | 69 | 56 | |
| 180 REC 102/6 | 44 | 60 | | 158 | 131 | 126 | 120 | 114 | 106 | 97 | 83 | 67 | |
| 180 REC 102/7 | 55 | 75 | | 184 | 153 | 147 | 140 | 133 | 124 | 113 | 97 | 78 | |
| 180 REC 102/8 | 66 | 90 | | 210 | 175 | 168 | 160 | 152 | 142 | 129 | 111 | 89 | |
| 180 REC 102/9 | 66 | 90 | | 237 | 197 | 189 | 180 | 171 | 159 | 145 | 125 | 100 | |
| 180 REC 102/10 | 75 | 100 | | 263 | 219 | 210 | 200 | 190 | 177 | 161 | 139 | 111 | |
| 180 REC 102/11 | 92 | 125 | | 289 | 240 | 231 | 220 | 209 | 195 | 178 | 152 | 123 | |
| 180 REC 102/12 | 92 | 125 | | 315 | 262 | 252 | 240 | 228 | 213 | 194 | 166 | 134 | |
| 180 REC 102/13 | 92 | 125 | | 342 | 284 | 273 | 260 | 247 | 230 | 210 | 180 | 145 | |

DIMENSIONI D'INGOMBRO E PESI - OVERALL DIMENSIONS AND WEIGHTS

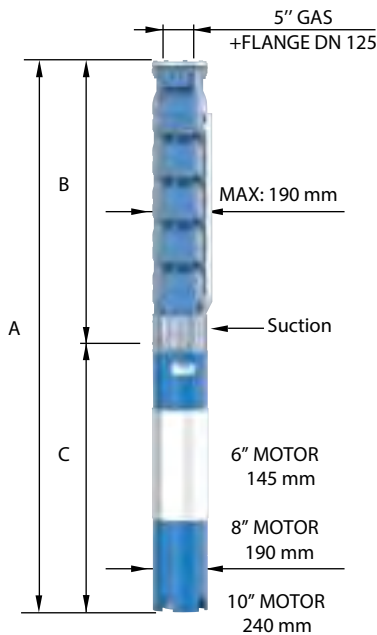

| Type | A mm Tri V 400 | B mm | C mm Tri | M Kg Tri | P Kg |
|----------------|-------------------|------|----------|----------|------|
| 180 REC 102/1 | 1228 | 527 | 701 | 55 | 23 |
| 180 REC 102/2 | 1583 | 652 | 931 | 75 | 32 |
| 180 REC 102/3 | 1848 | 777 | 1071 | 92 | 40 |
| 180 REC 102/4 | 2153 | 902 | 1251 | 108 | 49 |
| 180 REC 102/5 | 2368 | 1027 | 1341 | 118 | 58 |
| 180 REC 102/6 | 2275 | 1152 | 1123 | 178 | 66 |
| 180 REC 102/7 | 2510 | 1277 | 1233 | 200 | 75 |
| 180 REC 102/8 | 2705 | 1402 | 1303 | 214 | 83 |
| 180 REC 102/9 | 2830 | 1527 | 1303 | 214 | 92 |
| 180 REC 102/10 | 3035 | 1652 | 1383 | 230 | 101 |
| 180 REC 102/11 | 3360 | 1777 | 1583 | 270 | 109 |
| 180 REC 102/12 | 3485 | 1902 | 1583 | 270 | 118 |
| 180 REC 102/13 | 3610 | 2027 | 1583 | 270 | 126 |

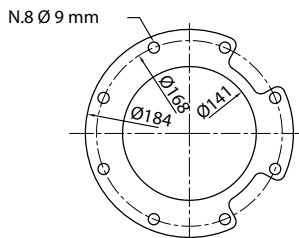

FOR COMMERCIAL PIPE
EXTERNAL DIAMETER: 139,7 mm

n% = Rendimento della pompa
n% = Rendement de la pompe
n% = Pump efficiency
n% = Rendimiento de la bomba

**Max
74%**

kW/st = Assorbimento per stadio
kW/st = Absorption par étage
kW/st = Stage absorption
kW/st = Potencia absorbida por etapa

**Max
7,3**

Tolleranza alla sabbia 50 g/m³ - Sand tolerance 50 g/m³
Tolleranze secondo UNI ISO 9906 livello 3B - Tolerances according to UNI ISO 9906 grade 3B

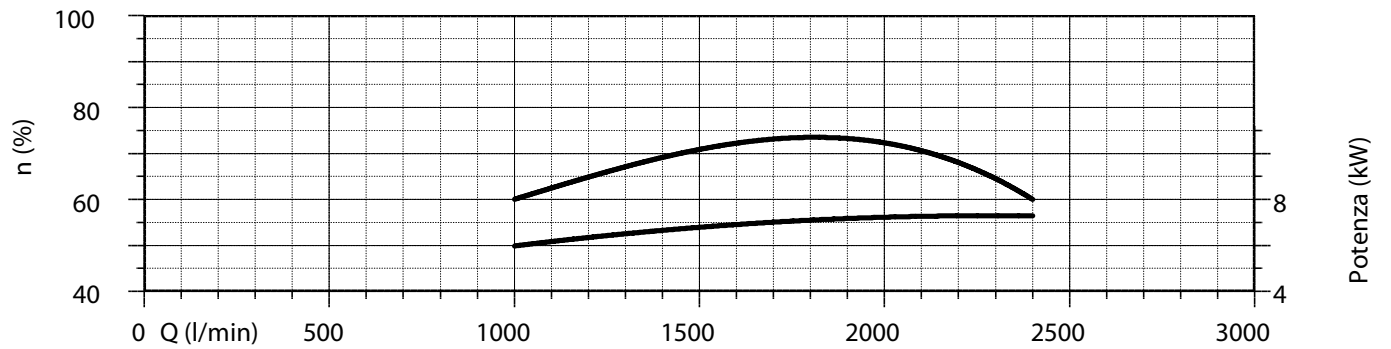
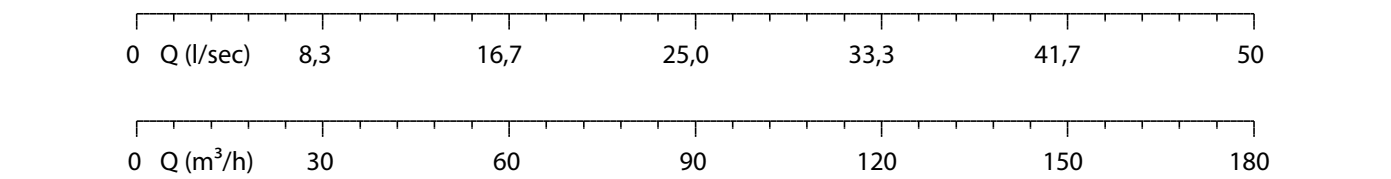
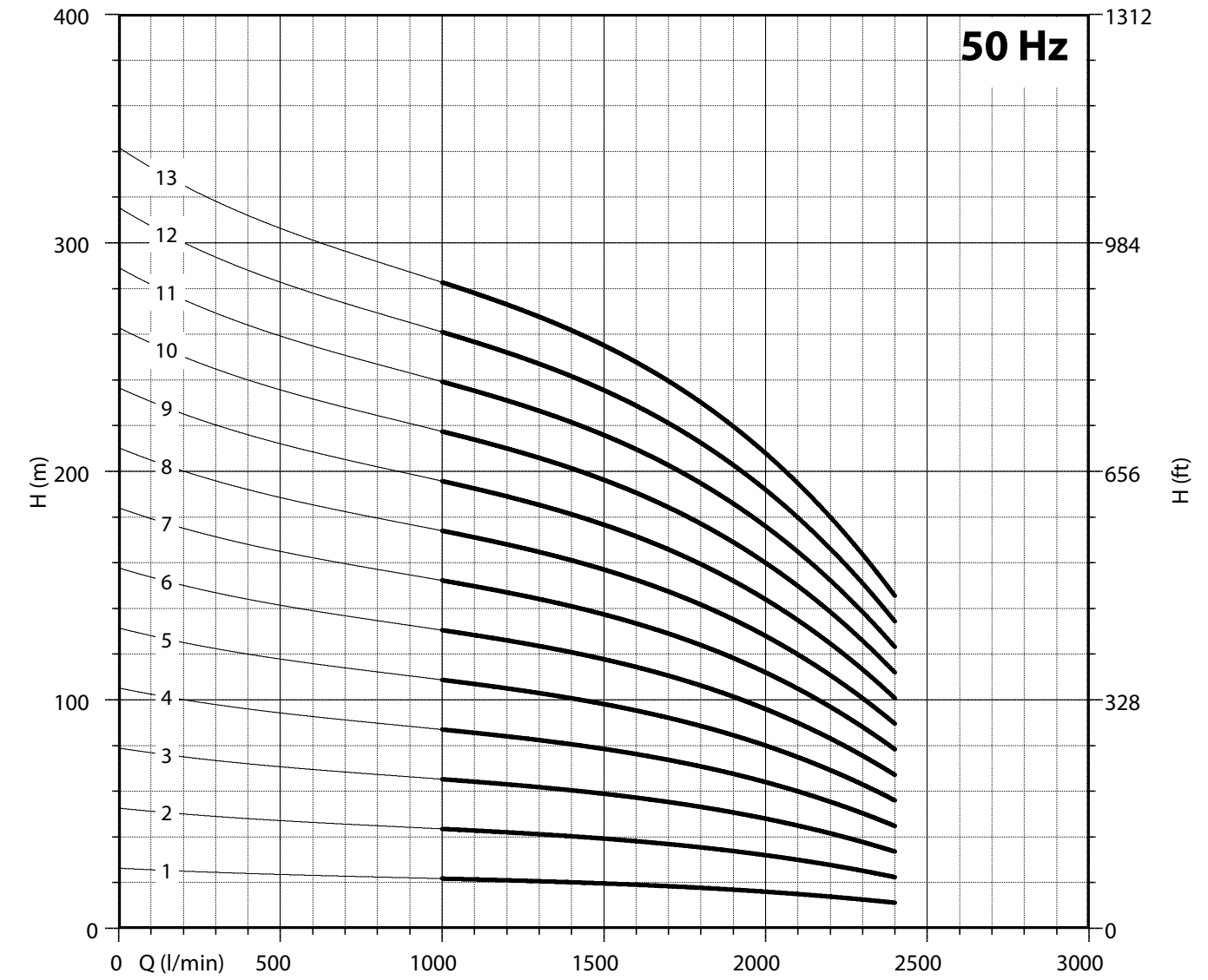

| NPSH (m) | 25% | 50% | 75% | 100% |
|-------------|-----|-----|-----|------|
| 180 REC 102 | 2,5 | 3,5 | 4,5 | 8 |

CARATTERISTICHE IDRAULICHE - HYDRAULIC PERFORMANCES

Q= Portata - Capacity - Debit **50 Hz n= 2900 min**

| Tipo Type | Power | | H(m) | l/min | 0 | 1200 | 1400 | 1600 | 1800 | 2000 | 2200 | 2400 | 2600 | 2800 |
|----------------|-------|-----|------|-------------------|-----|------|-------|-------|------|-------|-------|------|-------|-------|
| | kW | HP | | l/sec | 0 | 20 | 23,33 | 26,67 | 30 | 33,33 | 36,67 | 40 | 43,33 | 46,67 |
| | | | | m ³ /h | 0 | 72 | 84 | 96 | 108 | 120 | 132 | 144 | 156 | 168 |
| 180 REC 124/1 | 7,5 | 10 | | 26 | 21 | 20 | 19 | 18 | 17 | 15 | 13 | 11 | 8 | |
| 180 REC 124/2 | 15 | 20 | | 53 | 42 | 41 | 38 | 36 | 34 | 31 | 27 | 21 | 15 | |
| 180 REC 124/3 | 26 | 35 | | 79 | 63 | 61 | 57 | 54 | 51 | 46 | 40 | 32 | 23 | |
| 180 REC 124/4 | 30 | 40 | | 106 | 85 | 81 | 77 | 73 | 67 | 62 | 54 | 43 | 30 | |
| 180 REC 124/5 | 44 | 60 | | 132 | 106 | 101 | 96 | 91 | 84 | 77 | 67 | 54 | 38 | |
| 180 REC 124/6 | 55 | 75 | | 159 | 127 | 122 | 115 | 109 | 101 | 93 | 81 | 64 | 45 | |
| 180 REC 124/7 | 55 | 75 | | 185 | 148 | 142 | 134 | 127 | 118 | 108 | 94 | 75 | 53 | |
| 180 REC 124/8 | 66 | 90 | | 211 | 169 | 162 | 153 | 145 | 135 | 123 | 107 | 86 | 61 | |
| 180 REC 124/9 | 75 | 100 | | 238 | 190 | 183 | 172 | 163 | 152 | 139 | 121 | 96 | 68 | |
| 180 REC 124/10 | 75 | 100 | | 264 | 211 | 203 | 191 | 181 | 169 | 154 | 134 | 107 | 76 | |
| 180 REC 124/11 | 92 | 125 | | 291 | 233 | 223 | 211 | 200 | 185 | 170 | 148 | 118 | 83 | |
| 180 REC 124/12 | 92 | 125 | | 317 | 254 | 243 | 230 | 218 | 202 | 185 | 161 | 129 | 91 | |
| 180 REC 124/13 | 110 | 150 | | 344 | 275 | 264 | 249 | 236 | 219 | 201 | 175 | 139 | 98 | |
| 180 REC 124/14 | 110 | 150 | | 370 | 296 | 284 | 268 | 254 | 236 | 216 | 188 | 150 | 106 | |

DIMENSIONI D'INGOMBRO E PESI - OVERALL DIMENSIONS AND WEIGHTS

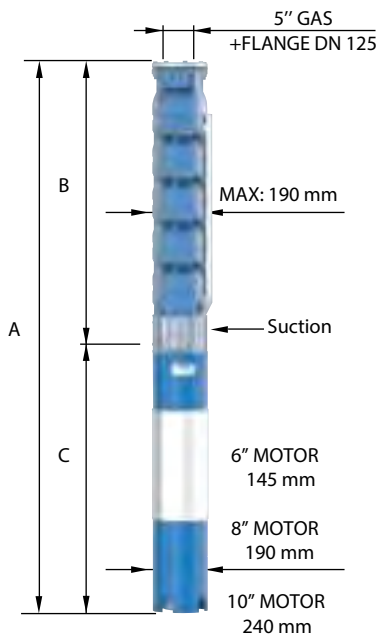

| Type | A mm Tri V 400 | B mm | C mm Tri | M Kg Tri | P Kg |
|----------------|-------------------|------|----------|----------|------|
| 180 REC 124/1 | 1228 | 527 | 701 | 55 | 23 |
| 180 REC 124/2 | 1583 | 652 | 931 | 75 | 32 |
| 180 REC 124/3 | 1958 | 777 | 1181 | 100 | 41 |
| 180 REC 124/4 | 2153 | 902 | 1251 | 108 | 49 |
| 180 REC 124/5 | 2150 | 1027 | 1123 | 178 | 58 |
| 180 REC 124/6 | 2385 | 1152 | 1233 | 200 | 67 |
| 180 REC 124/7 | 2510 | 1277 | 1233 | 200 | 75 |
| 180 REC 124/8 | 2705 | 1402 | 1303 | 214 | 84 |
| 180 REC 124/9 | 2910 | 1527 | 1383 | 230 | 93 |
| 180 REC 124/10 | 3035 | 1652 | 1383 | 230 | 102 |
| 180 REC 124/11 | 3360 | 1777 | 1583 | 270 | 110 |
| 180 REC 124/12 | 3485 | 1902 | 1583 | 270 | 119 |
| 180 REC 124/13 | 3760 | 2027 | 1733 | 300 | 128 |
| 180 REC 124/14 | 3885 | 2152 | 1733 | 300 | 136 |

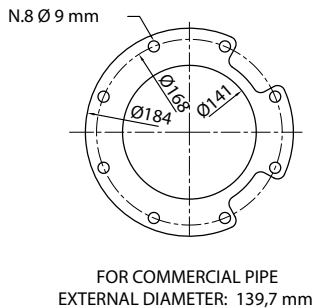

n% = Rendimento della pompa
 n% = Rendement de la pompe
 n% = Pump efficiency
 n% = Rendimiento de la bomba

**Max
75%**

kW/st = Assorbimento per stadio
 kW/st = Absorption par étage
 kW/st = Stage absorption
 kW/st = Potencia absorbida por etapa

**Max
7,7**

Tolleranza alla sabbia 50 g/m³ - Sand tolerance 50 g/m³
 Tolleranze secondo UNI ISO 9906 livello 3B - Tolerances according to UNI ISO 9906 grade 3B

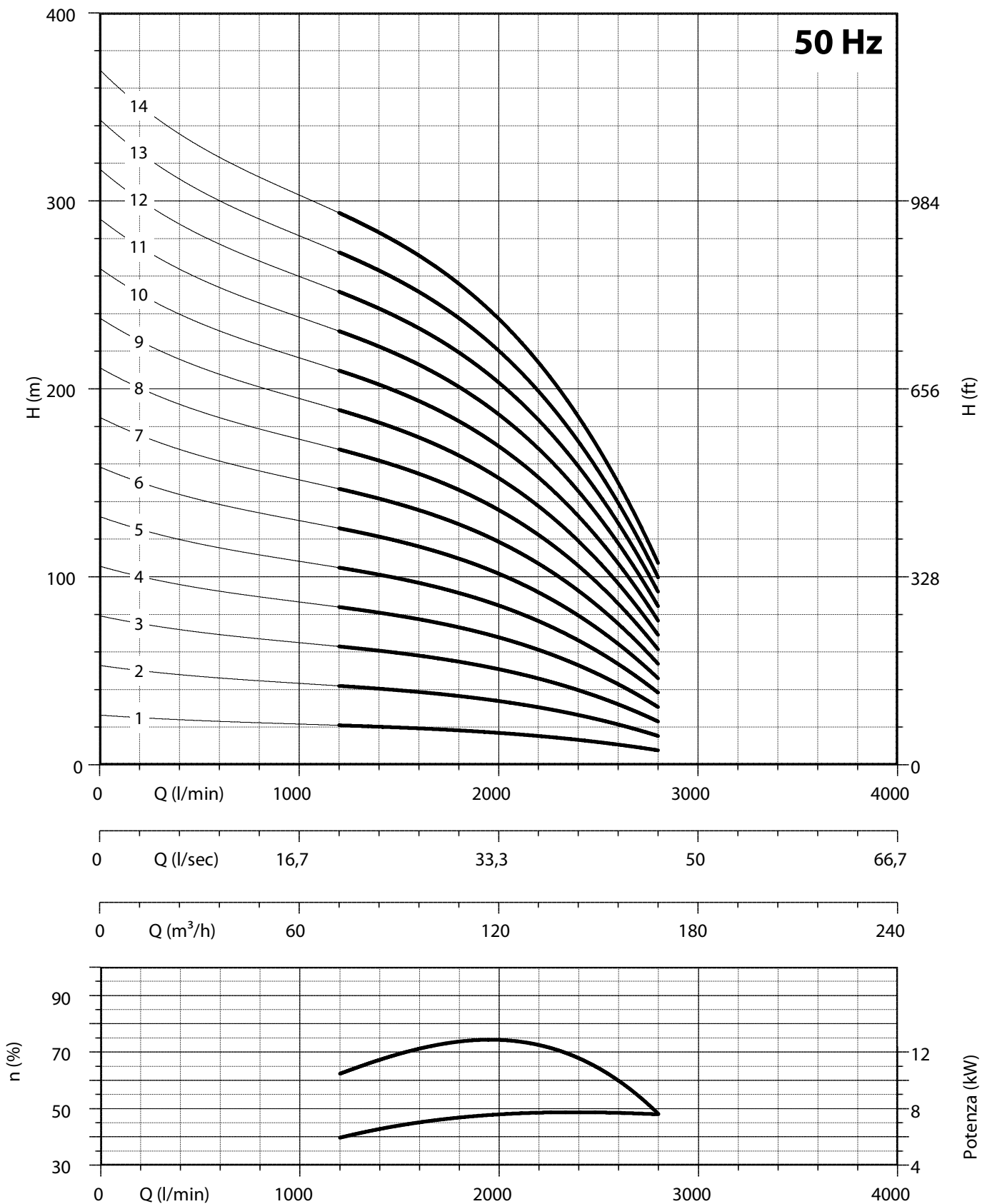

| NPSH (m) | 25% | 50% | 75% | 100% |
|-------------|-----|-----|-----|------|
| 180 REC 124 | 2,5 | 3 | 5 | 9 |

CARATTERISTICHE IDRAULICHE - HYDRAULIC PERFORMANCES

Q= Portata - Capacity - Debit

50 Hz n= 2900 min

| Tipo Type | Power | | H(m) | l/min | 0 | 1600 | 1800 | 2000 | 2200 | 2400 | 2600 | 2800 | 3000 | 3200 |
|----------------|-------|------|------|-------------------|-----|-------|------|-------|-------|------|-------|-------|------|-------|
| | kW | HP | | l/sec | 0 | 26,67 | 30 | 33,33 | 36,67 | 40 | 43,33 | 46,67 | 50 | 53,33 |
| | | | | m ³ /h | 0 | 96 | 108 | 120 | 132 | 144 | 156 | 168 | 180 | 192 |
| 180 REC 160/1 | 9,2 | 12,5 | | 24 | 19 | 18 | 17 | 16 | 16 | 15 | 13 | 12 | 10 | |
| 180 REC 160/2 | 18,5 | 25 | | 49 | 38 | 36 | 35 | 33 | 31 | 30 | 27 | 24 | 20 | |
| 180 REC 160/3 | 26 | 35 | | 73 | 57 | 54 | 52 | 49 | 47 | 45 | 40 | 36 | 30 | |
| 180 REC 160/4 | 37 | 50 | | 97 | 76 | 72 | 69 | 66 | 63 | 59 | 54 | 48 | 40 | |
| 180 REC 160/5 | 44 | 60 | | 121 | 95 | 90 | 86 | 82 | 79 | 74 | 67 | 60 | 50 | |
| 180 REC 160/6 | 55 | 75 | | 146 | 114 | 108 | 104 | 99 | 94 | 89 | 81 | 72 | 60 | |
| 180 REC 160/7 | 66 | 90 | | 170 | 133 | 126 | 121 | 115 | 110 | 104 | 94 | 84 | 70 | |
| 180 REC 160/8 | 75 | 100 | | 194 | 152 | 144 | 138 | 131 | 126 | 119 | 107 | 96 | 80 | |
| 180 REC 160/9 | 75 | 100 | | 219 | 171 | 162 | 156 | 148 | 141 | 134 | 121 | 108 | 90 | |
| 180 REC 160/10 | 92 | 125 | | 243 | 190 | 180 | 173 | 164 | 157 | 149 | 134 | 120 | 100 | |
| 180 REC 160/11 | 92 | 125 | | 267 | 209 | 198 | 190 | 181 | 173 | 163 | 148 | 132 | 110 | |
| 180 REC 160/12 | 110 | 150 | | 291 | 228 | 216 | 207 | 197 | 189 | 178 | 161 | 144 | 120 | |
| 180 REC 160/13 | 110 | 150 | | 316 | 247 | 234 | 225 | 214 | 204 | 193 | 175 | 156 | 130 | |

DIMENSIONI D'INGOMBRO E PESI - OVERALL DIMENSIONS AND WEIGHTS

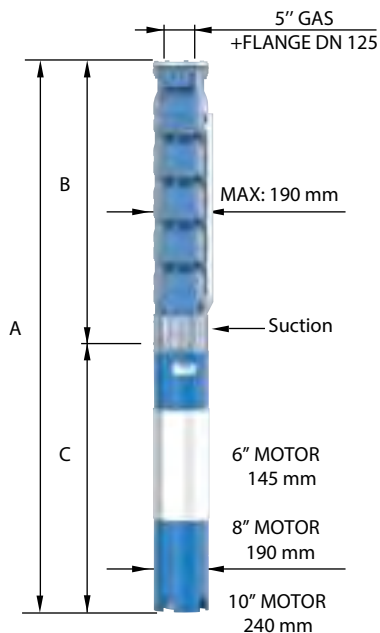

| Type | A mm Tri V 400 | B mm | C mm Tri | M Kg Tri | P Kg |
|----------------|-------------------|------|----------|----------|------|
| 180 REC 160/1 | 1303 | 552 | 751 | 60 | 24 |
| 180 REC 160/2 | 1693 | 702 | 991 | 83 | 33 |
| 180 REC 160/3 | 2033 | 852 | 1181 | 100 | 42 |
| 180 REC 160/4 | 2343 | 1002 | 1341 | 118 | 51 |
| 180 REC 160/5 | 2275 | 1152 | 1123 | 178 | 60 |
| 180 REC 160/6 | 2535 | 1302 | 1233 | 200 | 69 |
| 180 REC 160/7 | 2755 | 1452 | 1303 | 214 | 78 |
| 180 REC 160/8 | 2985 | 1602 | 1383 | 230 | 87 |
| 180 REC 160/9 | 3135 | 1752 | 1383 | 230 | 96 |
| 180 REC 160/10 | 3485 | 1902 | 1583 | 270 | 105 |
| 180 REC 160/11 | 3635 | 2052 | 1583 | 270 | 114 |
| 180 REC 160/12 | 3935 | 2202 | 1733 | 300 | 123 |
| 180 REC 160/13 | 4085 | 2352 | 1733 | 300 | 132 |

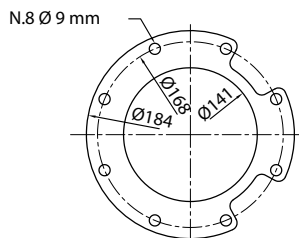

FOR COMMERCIAL PIPE
EXTERNAL DIAMETER: 139,7 mm

n% = Rendimento della pompa
n% = Rendement de la pompe
n% = Pump efficiency
n% = Rendimiento de la bomba

Max
74%

kW/st = Assorbimento per stadio
kW/st = Absorption par étage
kW/st = Stage absorption
kW/st = Potencia absorbida por etapa

Max
8,6

Tolleranza alla sabbia 50 g/m³ - Sand tolerance 50 g/m³
Tolleranze secondo UNI ISO 9906 livello 3B - Tolerances according to UNI ISO 9906 grade 3B

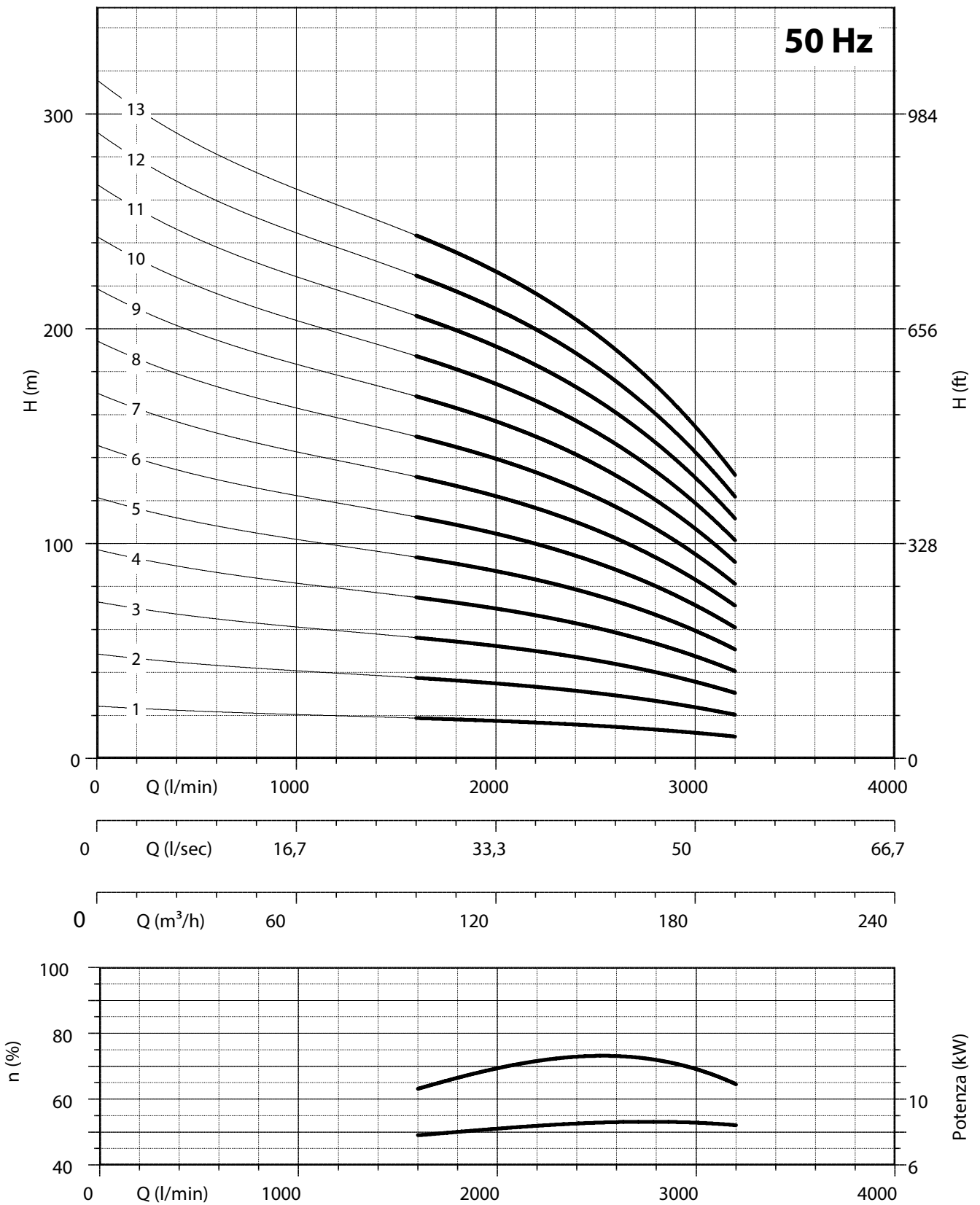

| NPSH (m) | 25% | 50% | 75% | 100% |
|-------------|-----|-----|-----|------|
| 180 REC 160 | 4 | 4,5 | 7 | 13 |

CARATTERISTICHE IDRAULICHE - HYDRAULIC PERFORMANCES

Q= Portata - Capacity - Debit 50 Hz n= 2900 min

| Tipo Type | Power | | H(m) | l/min | 1800 | 2200 | 2600 | 3000 | 3400 | 3800 |
|---------------------|-------|-----|------|-------|------|-------|-------|------|-------|-------|
| | kW | HP | | l/sec | 30 | 36,67 | 43,33 | 50 | 56,67 | 63,33 |
| | | | | m³/h | 0 | 108 | 132 | 156 | 180 | 204 |
| 230 REC 200/1 DR 20 | 15 | 20 | 32 | 29 | 28 | 25 | 24 | 20 | 16 | |
| 230 REC 200/1 DR 10 | 18,5 | 25 | 37 | 33 | 31 | 29 | 27 | 22 | 18 | |
| 230 REC 200/1 | 22 | 30 | 42 | 37 | 35 | 32 | 30 | 25 | 20 | |
| 230 REC 200/2 DR 20 | 30 | 40 | 65 | 58 | 55 | 50 | 48 | 40 | 32 | |
| 230 REC 200/2 DR 10 | 37 | 50 | 73 | 66 | 62 | 57 | 54 | 45 | 36 | |
| 230 REC 200/2 | 44 | 60 | 83 | 74 | 70 | 64 | 60 | 50 | 40 | |
| 230 REC 200/3 DR 20 | 55 | 75 | 97 | 88 | 83 | 76 | 71 | 59 | 47 | |
| 230 REC 200/3 DR 10 | 55 | 75 | 110 | 99 | 94 | 86 | 80 | 67 | 53 | |
| 230 REC 200/3 | 66 | 90 | 125 | 111 | 105 | 96 | 90 | 75 | 60 | |
| 230 REC 200/4 DR 20 | 66 | 90 | 130 | 117 | 110 | 101 | 95 | 79 | 63 | |
| 230 REC 200/4 DR 10 | 75 | 100 | 146 | 132 | 125 | 114 | 107 | 90 | 71 | |
| 230 REC 200/4 | 75 | 100 | 166 | 148 | 140 | 128 | 120 | 100 | 80 | |
| 230 REC 200/5 DR 20 | 75 | 100 | 162 | 146 | 138 | 126 | 119 | 99 | 79 | |
| 230 REC 200/5 DR 10 | 92 | 125 | 183 | 165 | 156 | 143 | 134 | 112 | 89 | |
| 230 REC 200/5 | 110 | 150 | 208 | 185 | 175 | 160 | 150 | 125 | 100 | |
| 230 REC 200/6 DR 20 | 92 | 125 | 194 | 175 | 166 | 151 | 143 | 119 | 95 | |
| 230 REC 200/6 DR 10 | 110 | 150 | 220 | 198 | 187 | 172 | 161 | 134 | 107 | |
| 230 REC 200/6 | 129 | 175 | 250 | 222 | 210 | 192 | 180 | 150 | 120 | |
| 230 REC 200/7 DR 20 | 110 | 150 | 227 | 204 | 193 | 176 | 167 | 139 | 111 | |
| 230 REC 200/7 DR 10 | 129 | 175 | 256 | 231 | 218 | 200 | 188 | 157 | 125 | |
| 230 REC 200/7 | 147 | 200 | 291 | 259 | 245 | 224 | 210 | 175 | 140 | |
| 230 REC 200/8 DR 20 | 129 | 175 | 259 | 234 | 221 | 202 | 190 | 158 | 126 | |
| 230 REC 200/8 DR 10 | 147 | 200 | 293 | 264 | 250 | 229 | 214 | 179 | 142 | |
| 230 REC 200/8 | 165 | 225 | 333 | 296 | 280 | 256 | 240 | 200 | 160 | |

DIMENSIONI D'INGOMBRO E PESI - OVERALL DIMENSIONS AND WEIGHTS

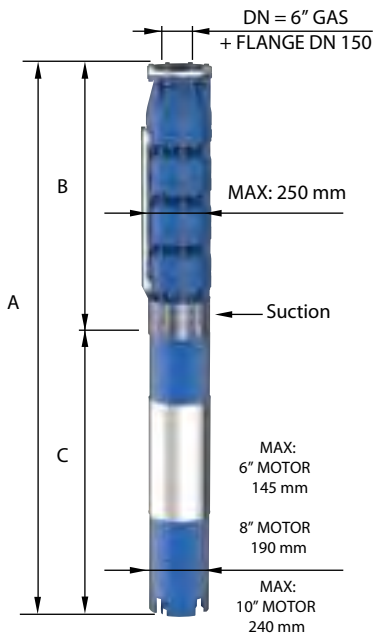

| Type | A mm Tri V 400 | B mm | C mm Tri | M Kg Tri | P Kg |
|---------------------|-------------------|------|----------|----------|------|
| 230 REC 200/1 DR 20 | 1556 | 625 | 931 | 75 | 50 |
| 230 REC 200/1 DR 10 | 1616 | 625 | 991 | 83 | 50 |
| 230 REC 200/1 | 1696 | 625 | 1071 | 92 | 50 |
| 230 REC 200/2 DR 20 | 2056 | 805 | 1251 | 108 | 68 |
| 230 REC 200/2 DR 10 | 2146 | 805 | 1341 | 118 | 68 |
| 230 REC 200/2 | 1928 | 805 | 1123 | 178 | 68 |
| 230 REC 200/3 DR 20 | 2218 | 985 | 1233 | 200 | 87 |
| 230 REC 200/3 DR 10 | 2218 | 985 | 1233 | 200 | 87 |
| 230 REC 200/3 | 2288 | 985 | 1303 | 214 | 87 |
| 230 REC 200/4 DR 20 | 2468 | 1165 | 1303 | 214 | 105 |
| 230 REC 200/4 DR 10 | 2548 | 1165 | 1383 | 230 | 105 |
| 230 REC 200/4 | 2548 | 1165 | 1383 | 230 | 105 |
| 230 REC 200/5 DR 20 | 2728 | 1345 | 1383 | 230 | 124 |
| 230 REC 200/5 DR 10 | 2928 | 1345 | 1583 | 270 | 124 |
| 230 REC 200/5 | 3078 | 1345 | 1733 | 300 | 124 |
| 230 REC 200/6 DR 20 | 3108 | 1525 | 1583 | 270 | 142 |
| 230 REC 200/6 DR 10 | 3258 | 1525 | 1733 | 300 | 142 |
| 230 REC 200/6 | 3159 | 1525 | 1634 | 385 | 142 |
| 230 REC 200/7 DR 20 | 3438 | 1705 | 1733 | 300 | 161 |
| 230 REC 200/7 DR 10 | 3339 | 1705 | 1634 | 385 | 161 |
| 230 REC 200/7 | 3439 | 1705 | 1734 | 415 | 161 |
| 230 REC 200/8 DR 20 | 3519 | 1885 | 1634 | 385 | 179 |
| 230 REC 200/8 DR 10 | 3619 | 1885 | 1734 | 415 | 179 |
| 230 REC 200/8 | 3739 | 1885 | 1854 | 444 | 179 |

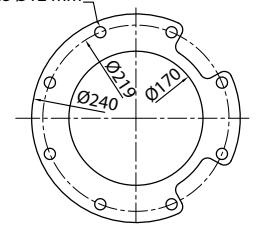

FOR COMMERCIAL TUBE
EXTERNAL DIAMETER: 168,3 mm

n% = Rendimento della pompa
n% = Rendement de la pompe
n% = Pump efficiency
n% = Rendimiento de la bomba

Max
75,5%

DR 10
Max 75%

DR 20
Max 74%

kW/st = Assorbimento per stadio
kW/st = Absorption par étage
kW/st = Stage absorption
kW/st = Potencia absorbida por etapa

Max
19,4

DR 10
Max 17,5

DR 20
Max 15,7

Tolleranza alla sabbia 50 g/m³ - Sand tolerance 50 g/m³
Tolleranze secondo UNI ISO 9906 livello 3B - Tolerances according to UNI ISO 9906 grade 3B

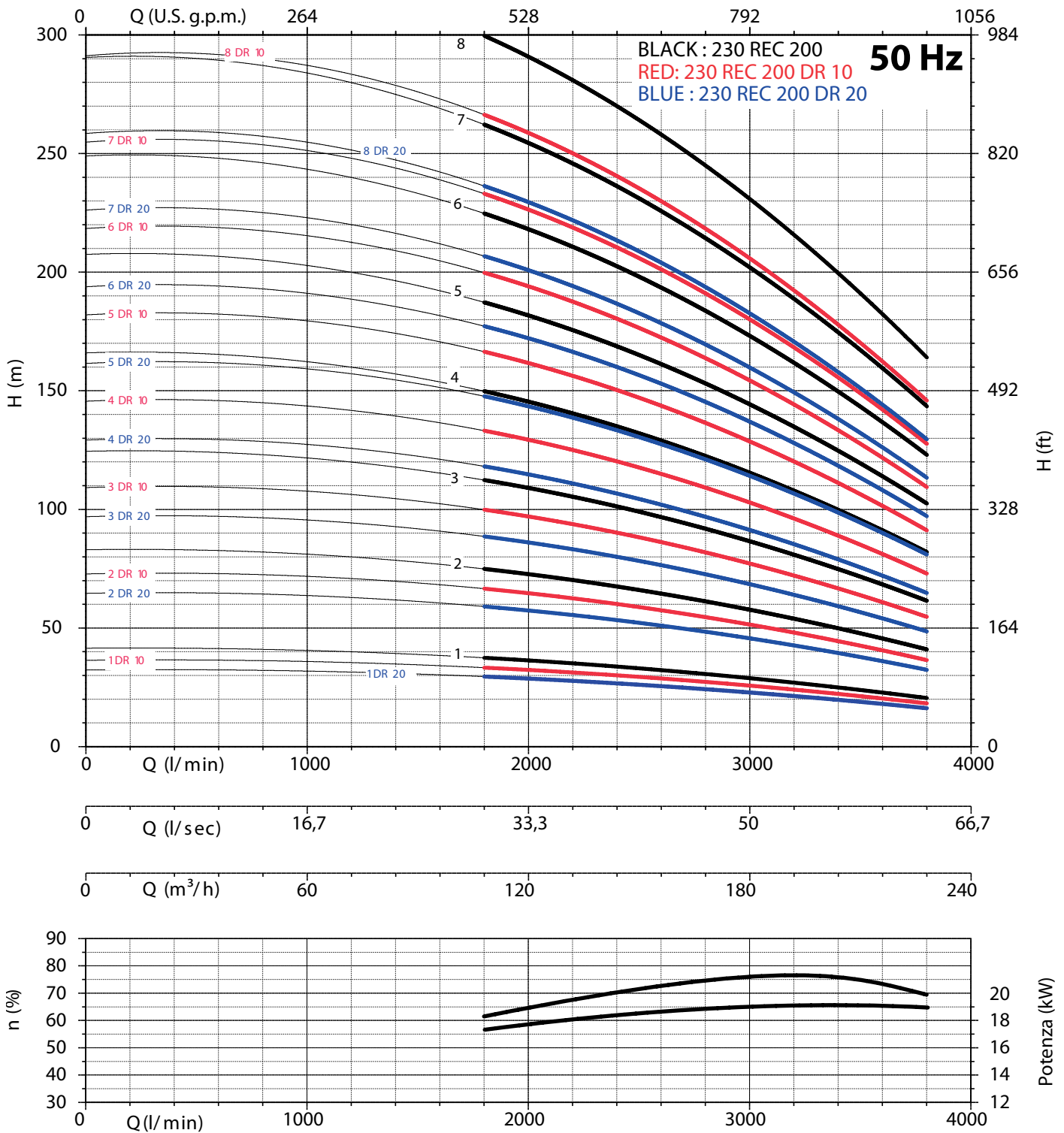

| NPSH (m) | 25% | 50% | 75% | 100% |
|-------------|-----|-----|-----|------|
| 230 REC 200 | 3,6 | 5,3 | 8,1 | 14 |

CARATTERISTICHE IDRAULICHE - HYDRAULIC PERFORMANCES

Q= Portata - Capacity - Debit **50 Hz n= 2900 min**

| Tipo Type | Power | | H(m) | l/min | 0 | 2200 | 2600 | 3000 | 3400 | 3800 | 4200 | 4400 |
|---------------------|-------|-----|------|-------------------|-----|-------|-------|------|-------|-------|------|-------|
| | kW | HP | | l/sec | 0 | 36,67 | 43,33 | 50 | 56,67 | 63,33 | 70 | 73,33 |
| | | | | m ³ /h | 0 | 132 | 156 | 180 | 204 | 228 | 252 | 264 |
| 230 REC 220/1 DR 20 | 18,5 | 25 | | 34 | 29 | 28 | 26 | 24 | 24 | 22 | 19 | 16 |
| 230 REC 220/1 DR 10 | 22 | 30 | | 38 | 33 | 31 | 29 | 27 | 27 | 25 | 21 | 17 |
| 230 REC 220/1 | 22 | 30 | | 43 | 37 | 35 | 33 | 30 | 30 | 28 | 24 | 22 |
| 230 REC 220/2 DR 20 | 37 | 50 | | 68 | 58 | 55 | 52 | 48 | 48 | 44 | 38 | 33 |
| 230 REC 220/2 DR 10 | 44 | 60 | | 77 | 66 | 62 | 59 | 54 | 54 | 50 | 43 | 35 |
| 230 REC 220/2 | 44 | 60 | | 86 | 74 | 70 | 66 | 60 | 60 | 56 | 48 | 44 |
| 230 REC 220/3 DR 20 | 55 | 75 | | 102 | 88 | 83 | 78 | 71 | 71 | 67 | 57 | 49 |
| 230 REC 220/3 DR 10 | 66 | 90 | | 115 | 99 | 94 | 88 | 80 | 80 | 75 | 64 | 52 |
| 230 REC 220/3 | 75 | 100 | | 129 | 111 | 105 | 99 | 90 | 90 | 84 | 72 | 66 |
| 230 REC 220/4 DR 20 | 75 | 100 | | 136 | 117 | 110 | 104 | 95 | 95 | 89 | 76 | 66 |
| 230 REC 220/4 DR 10 | 92 | 125 | | 154 | 132 | 125 | 118 | 107 | 107 | 100 | 86 | 70 |
| 230 REC 220/4 | 92 | 125 | | 172 | 148 | 140 | 132 | 120 | 120 | 112 | 96 | 88 |
| 230 REC 220/5 DR 20 | 92 | 125 | | 170 | 146 | 138 | 130 | 119 | 119 | 111 | 95 | 82 |
| 230 REC 220/5 DR 10 | 110 | 150 | | 192 | 165 | 156 | 147 | 134 | 134 | 125 | 107 | 87 |
| 230 REC 220/5 | 129 | 175 | | 215 | 185 | 175 | 165 | 150 | 150 | 140 | 120 | 110 |
| 230 REC 220/6 DR 20 | 110 | 150 | | 204 | 175 | 166 | 156 | 143 | 143 | 133 | 114 | 98 |
| 230 REC 220/6 DR 10 | 129 | 175 | | 230 | 198 | 187 | 176 | 161 | 161 | 150 | 128 | 104 |
| 230 REC 220/6 | 147 | 200 | | 258 | 222 | 210 | 198 | 180 | 180 | 168 | 144 | 132 |
| 230 REC 220/7 DR 20 | 129 | 175 | | 238 | 204 | 193 | 182 | 167 | 167 | 155 | 133 | 115 |
| 230 REC 220/7 DR 10 | 147 | 200 | | 269 | 231 | 218 | 206 | 188 | 188 | 175 | 150 | 122 |
| 230 REC 220/7 | 165 | 225 | | 301 | 259 | 245 | 231 | 210 | 210 | 196 | 168 | 154 |

DIMENSIONI D'INGOMBRO E PESI - OVERALL DIMENSIONS AND WEIGHTS

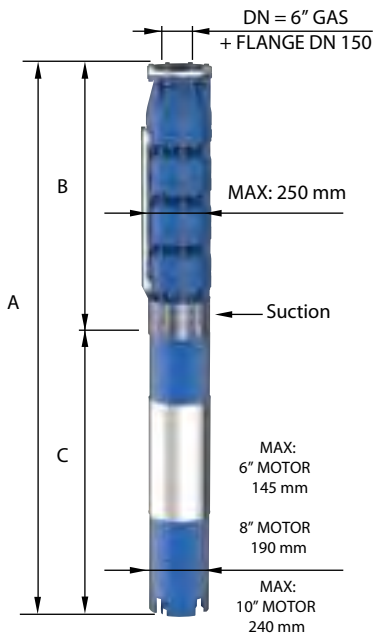

| Type | A mm Tri V 400 | B mm | C mm Tri | M Kg Tri | P Kg |
|---------------------|-------------------|------|----------|----------|------|
| 230 REC 220/1 DR 20 | 1616 | 625 | 991 | 83 | 50 |
| 230 REC 220/1 DR 10 | 1696 | 625 | 1071 | 92 | 50 |
| 230 REC 220/1 | 1696 | 625 | 1071 | 92 | 50 |
| 230 REC 220/2 DR 20 | 2146 | 805 | 1341 | 118 | 68 |
| 230 REC 220/2 DR 10 | 1928 | 805 | 1123 | 178 | 68 |
| 230 REC 220/2 | 1928 | 805 | 1123 | 178 | 68 |
| 230 REC 220/3 DR 20 | 2218 | 985 | 1233 | 200 | 87 |
| 230 REC 220/3 DR 10 | 2288 | 985 | 1303 | 214 | 87 |
| 230 REC 220/3 | 2368 | 985 | 1383 | 230 | 87 |
| 230 REC 220/4 DR 20 | 2548 | 1165 | 1383 | 230 | 105 |
| 230 REC 220/4 DR 10 | 2748 | 1165 | 1583 | 270 | 105 |
| 230 REC 220/4 | 2748 | 1165 | 1583 | 270 | 105 |
| 230 REC 220/5 DR 20 | 2928 | 1345 | 1583 | 270 | 124 |
| 230 REC 220/5 DR 10 | 3078 | 1345 | 1733 | 300 | 124 |
| 230 REC 220/5 | 2979 | 1345 | 1634 | 385 | 124 |
| 230 REC 220/6 DR 20 | 3258 | 1525 | 1733 | 300 | 142 |
| 230 REC 220/6 DR 10 | 3159 | 1525 | 1634 | 385 | 142 |
| 230 REC 220/6 | 3259 | 1525 | 1734 | 415 | 142 |
| 230 REC 220/7 DR 20 | 3339 | 1705 | 1634 | 385 | 161 |
| 230 REC 220/7 DR 10 | 3439 | 1705 | 1734 | 415 | 161 |
| 230 REC 220/7 | 3559 | 1705 | 1854 | 444 | 161 |

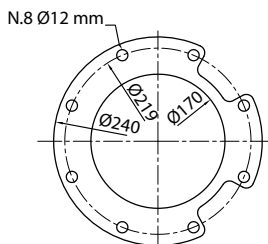

FOR COMMERCIAL TUBE
EXTERNAL DIAMETER: 168,3 mm

n% = Rendimento della pompa
n% = Rendement de la pompe
n% = Pump efficiency
n% = Rendimiento de la bomba

**Max
76,5%**

**DR 10
Max 76%**

**DR 20
Max 75,5%**

kW/st = Assorbimento per stadio
kW/st = Absorption par étage
kW/st = Stage absorption
kW/st = Potencia absorbida por etapa

**Max
23**

**DR 10
Max 20,5**

**DR 20
Max 18,3**

Tolleranza alla sabbia 50 g/m³ - Sand tolerance 50 g/m³
Tolleranze secondo UNI ISO 9906 livello 3B - Tolerances according to UNI ISO 9906 grade 3B

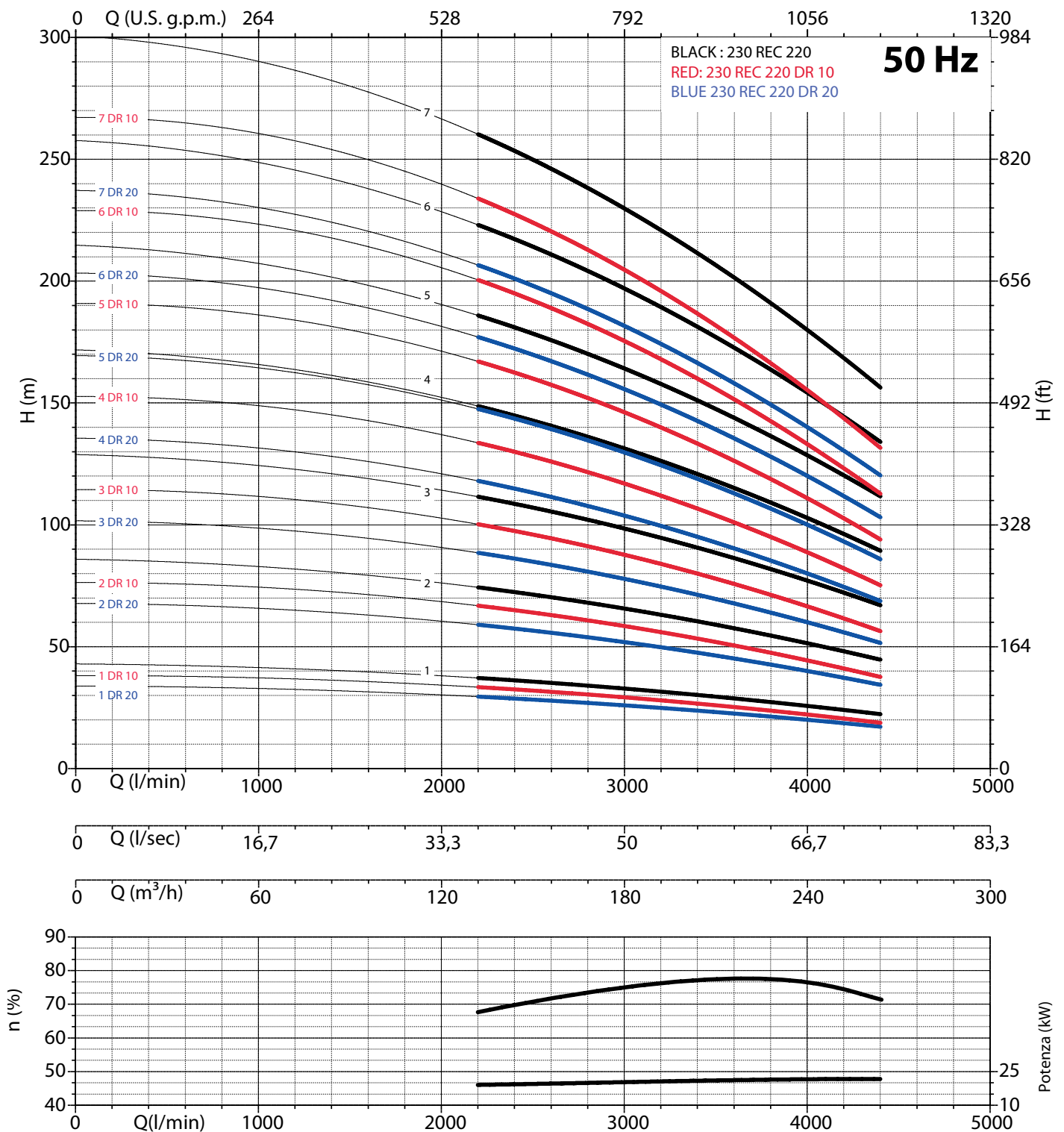

| NPSH (m) | 25% | 50% | 75% | 100% |
|-------------|-----|-----|-----|------|
| 230 REC 220 | 3,7 | 5,4 | 8,3 | 14,2 |

CARATTERISTICHE IDRAULICHE - HYDRAULIC PERFORMANCES

Q= Portata - Capacity - Debit **50 Hz n= 2900 min**

| Tipo Type | Power | | l/min | 0 | 2400 | 2800 | 3200 | 3600 | 4000 | 4400 | 4800 | 5000 | |
|---------------------|-------|-----|-------|-----|------|------|------|------|------|------|------|------|-------|
| | kW | HP | | | | | | | | | | | l/sec |
| | | | | | | | | | | | | | m³/h |
| 230 REC 240/1 DR 20 | 22 | 30 | 34 | 28 | 27 | 26 | 25 | 22 | 21 | 18 | 17 | | |
| 230 REC 240/1 DR 10 | 26 | 35 | 38 | 32 | 30 | 29 | 28 | 25 | 23 | 20 | 20 | | |
| 230 REC 240/1 | 26 | 35 | 43 | 36 | 34 | 33 | 31 | 28 | 26 | 23 | 22 | | |
| 230 REC 240/2 DR 20 | 44 | 60 | 68 | 57 | 54 | 52 | 49 | 44 | 41 | 36 | 35 | | |
| 230 REC 240/2 DR 10 | 55 | 75 | 77 | 64 | 61 | 59 | 55 | 50 | 46 | 41 | 39 | | |
| 230 REC 240/2 | 55 | 75 | 86 | 72 | 68 | 66 | 62 | 56 | 52 | 46 | 44 | | |
| 230 REC 240/3 DR 20 | 66 | 90 | 102 | 85 | 81 | 79 | 74 | 67 | 62 | 55 | 52 | | |
| 230 REC 240/3 DR 10 | 75 | 100 | 115 | 96 | 91 | 88 | 83 | 75 | 70 | 61 | 59 | | |
| 230 REC 240/3 | 92 | 125 | 129 | 108 | 102 | 99 | 93 | 84 | 78 | 69 | 66 | | |
| 230 REC 240/4 DR 20 | 92 | 125 | 136 | 114 | 108 | 105 | 98 | 89 | 82 | 73 | 70 | | |
| 230 REC 240/4 DR 10 | 92 | 125 | 154 | 128 | 122 | 118 | 110 | 100 | 93 | 82 | 78 | | |
| 230 REC 240/4 | 110 | 150 | 172 | 144 | 136 | 132 | 124 | 112 | 104 | 92 | 88 | | |
| 230 REC 240/5 DR 20 | 110 | 150 | 170 | 142 | 135 | 131 | 123 | 111 | 103 | 91 | 87 | | |
| 230 REC 240/5 DR 10 | 129 | 175 | 192 | 160 | 152 | 147 | 138 | 125 | 116 | 102 | 98 | | |
| 230 REC 240/5 | 129 | 175 | 215 | 180 | 170 | 165 | 155 | 140 | 130 | 115 | 110 | | |
| 230 REC 240/6 DR 20 | 129 | 175 | 204 | 170 | 162 | 157 | 148 | 133 | 124 | 109 | 104 | | |
| 230 REC 240/6 DR 10 | 147 | 200 | 230 | 192 | 182 | 176 | 166 | 150 | 139 | 122 | 118 | | |
| 230 REC 240/6 | 165 | 225 | 258 | 216 | 204 | 198 | 186 | 168 | 156 | 138 | 132 | | |
| 230 REC 240/7 DR 20 | 165 | 225 | 238 | 199 | 189 | 183 | 172 | 155 | 144 | 127 | 122 | | |
| 230 REC 240/7 DR 10 | 165 | 225 | 269 | 224 | 213 | 206 | 193 | 175 | 162 | 143 | 137 | | |

DIMENSIONI D'INGOMBRO E PESI - OVERALL DIMENSIONS AND WEIGHTS

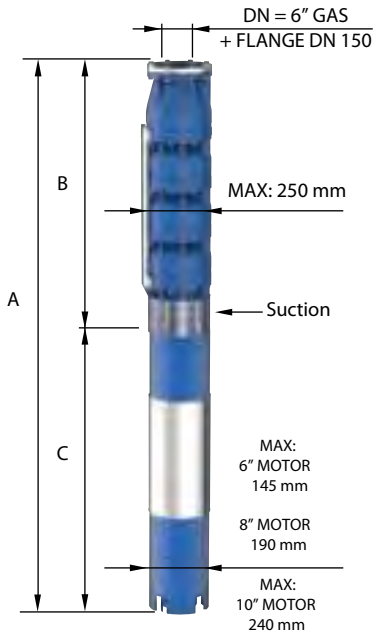

| Type | A mm Tri V 400 | B mm | C mm Tri | M Kg Tri | P Kg |
|---------------------|-------------------|------|----------|----------|------|
| 230 REC 240/1 DR 20 | 1696 | 625 | 1071 | 92 | 50 |
| 230 REC 240/1 DR 10 | 1806 | 625 | 1181 | 100 | 50 |
| 230 REC 240/1 | 1806 | 625 | 1181 | 100 | 50 |
| 230 REC 240/2 DR 20 | 1928 | 805 | 1123 | 178 | 68 |
| 230 REC 240/2 DR 10 | 2038 | 805 | 1233 | 200 | 68 |
| 230 REC 240/2 | 2038 | 805 | 1233 | 200 | 68 |
| 230 REC 240/3 DR 20 | 2288 | 985 | 1303 | 214 | 87 |
| 230 REC 240/3 DR 10 | 2368 | 985 | 1383 | 230 | 87 |
| 230 REC 240/3 | 2568 | 985 | 1583 | 270 | 87 |
| 230 REC 240/4 DR 20 | 2748 | 1165 | 1583 | 270 | 105 |
| 230 REC 240/4 DR 10 | 2748 | 1165 | 1583 | 270 | 105 |
| 230 REC 240/4 | 2898 | 1165 | 1733 | 300 | 105 |
| 230 REC 240/5 DR 20 | 3078 | 1345 | 1733 | 300 | 124 |
| 230 REC 240/5 DR 10 | 2979 | 1345 | 1634 | 385 | 124 |
| 230 REC 240/5 | 2979 | 1345 | 1634 | 385 | 124 |
| 230 REC 240/6 DR 20 | 3159 | 1525 | 1634 | 385 | 142 |
| 230 REC 240/6 DR 10 | 3259 | 1525 | 1734 | 415 | 142 |
| 230 REC 240/6 | 3379 | 1525 | 1854 | 444 | 142 |
| 230 REC 240/7 DR 20 | 3559 | 1705 | 1854 | 444 | 161 |
| 230 REC 240/7 DR 10 | 3559 | 1705 | 1854 | 444 | 161 |

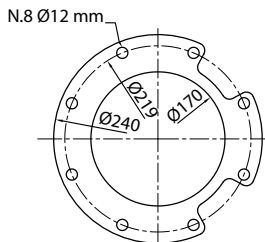

FOR COMMERCIAL TUBE
EXTERNAL DIAMETER: 168,3 mm

n% = Rendimento della pompa
n% = Rendement de la pompe
n% = Pump efficiency
n% = Rendimiento de la bomba

Max 76,5%

DR 10 Max 76%

DR 20 Max 75,5%

kW/st = Assorbimento per stadio
kW/st = Absorption par étage
kW/st = Stage absorption
kW/st = Potencia absorbida por etapa

Max 26,3

DR 10 Max 23,5

DR 20 Max 21,9

Tolleranza alla sabbia 50 g/m³ - Sand tolerance 50 g/m³
Tolleranze secondo UNI ISO 9906 livello 3B - Tolerances according to UNI ISO 9906 grade 3B

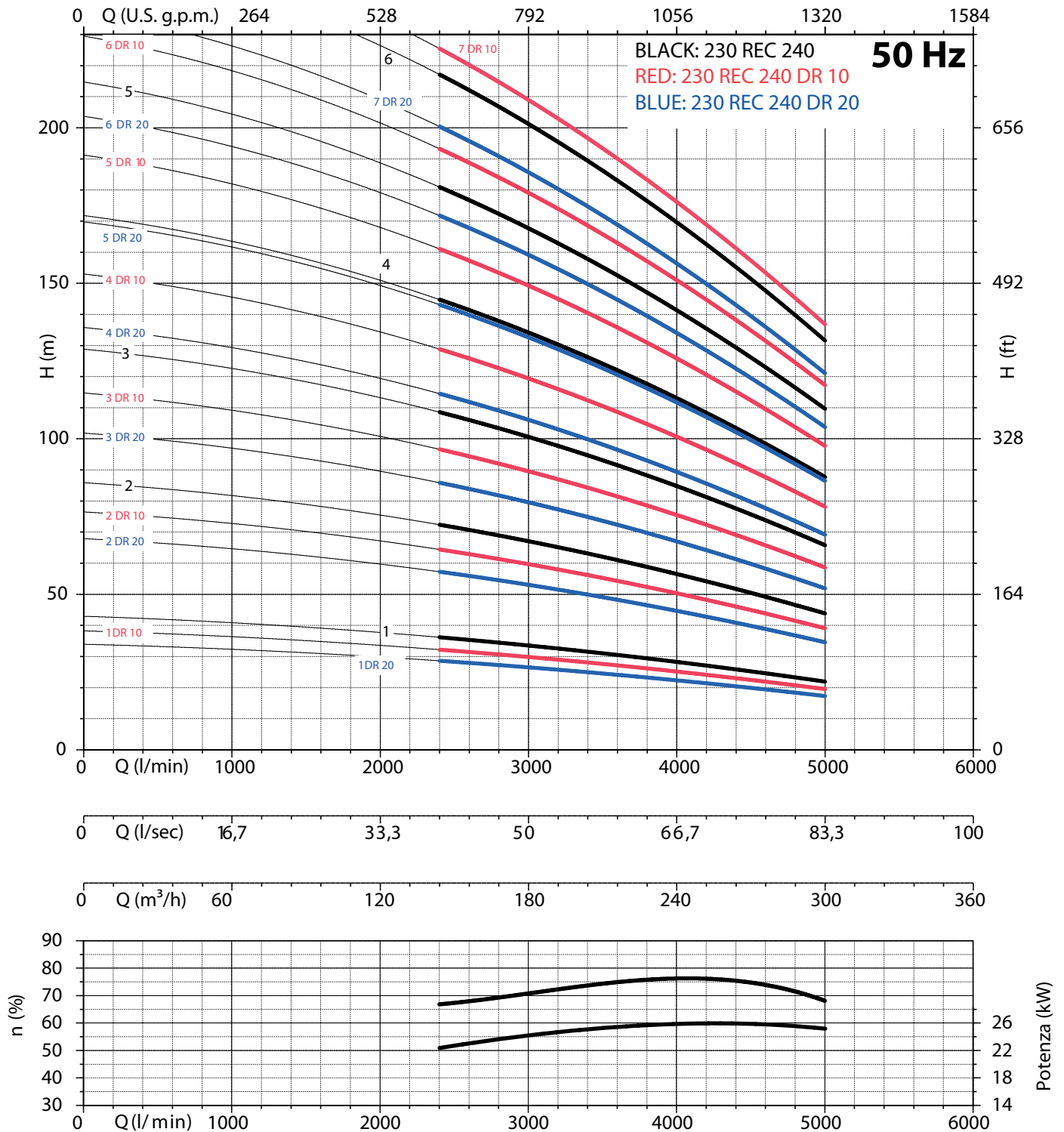

| NPSH (m) | 25% | 50% | 75% | 100% |
|-------------|-----|-----|-----|------|
| 230 REC 240 | 3,9 | 5,5 | 8,5 | 14,4 |